

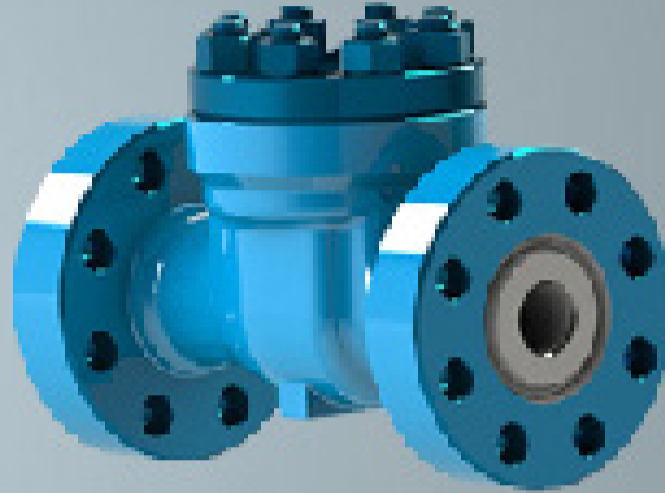

SHREE BRAHMANI

FORGE INDUSTRIES



OUR CONCERN IS QUALITY
NOT QUANTITY



8200919139
9723669083



103/5 GIDC Industrial
Area, Odhav,
Ahmedabad, Gujarat,
380038.



kishanpanchal@gmail.com



www.sbfindustries.com



Globe Valve



Gate Valve

An ISO 9001-2015 Certified Company

GATE VALVE (150# / 300#)

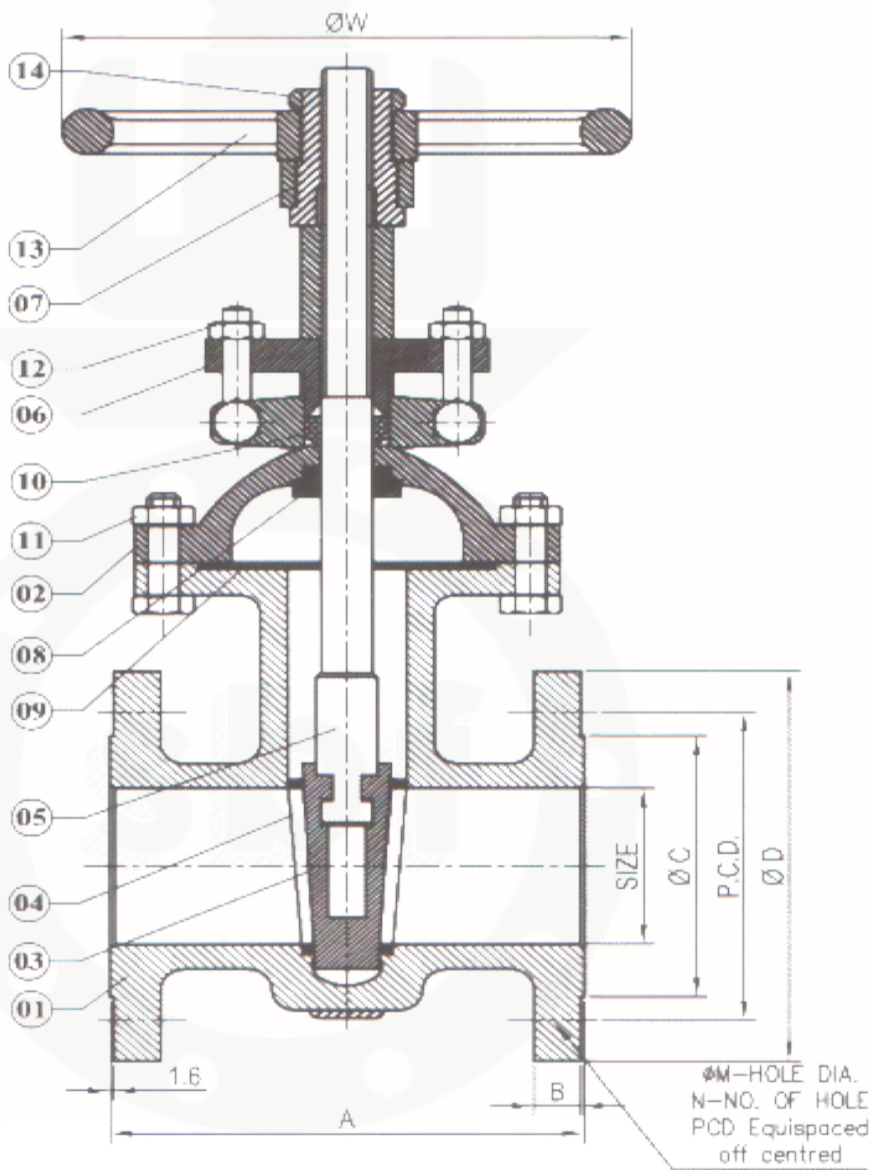

NO	DESCRIPTION	MATERIAL	QTY.
01	BODY	ASTM A216 Gr. WCB/CF8/CF8M	1
02	BONNET	ASTM A216 Gr. WCB/CF8/CF8M	1
03	WEDGE	ASTM A216 Gr. WCB/CF8/CF8M	1
04	SEAT RING	AISI 410(13% CR)/SS 304/ 316	2
05	STEM	AISI 410(13% CR)/SS 304/ 316	1
06	GLAND	CARBON STEEL	1
07	YOKE SLEEVE	NI-RESIST-NODULAR CAST IRON	1
08	BACK SEAT	AISI 410(13% CR)/SS 304/316	1
09	GASKET	SPRAL WOUND METALIC	1
10	GLAND PACKING	METALIC WIRE REINFORCE	-
		GRAPHOIL ASBESTOS	Req.
11	BONNET STUB & NUT	ASTM A193Gr. B7 / ASTM A 194 Gr. 2H	Req.
12	EYE BOLT & NUT	ASTM A193Gr. B7 / ASTM A 194 Gr. 2H	2SET
13	HAND WHEEL	S G IRON	1
14	HAND WHEEL NUT	CARBON STEEL	1

TECHNICAL DATA

DESIGN & MANUFACTURING STD.	BS-1414 / AP / 600
TESTING & INSPECTION STD.	AP I 598
END CONNECTIONS	FLANGED AS PER ANSI B/16.5
SEAL WALL THICKNESS	ANSI B 16.34
FACE TO FACE	AS PER ANSI / B 16.10

PRIMARY SERVICE RATING & TEST PRESSURE

CLASS	WORKING PRESS.	TEMP.	HYD. TEST PRESS	
			BODY	SEAT
150	150 PSID	500 ⁰ F	425 PSIG	300 PSIG
300	300 PSID	800 ⁰ F	1100 PSIG	800 PSIG

AIR TEST - SEAT - 80 PASIG + 10 PSIG

SIZE	CLASS - 150								
IN	M.M.	A	B	C	D	M	N	P.C.D.	W
1"	25	127.0	11.0	51	108.0	16	4	79.2	100
1.1/2"	40	165.1	14.2	73	127.0	16	4	98.5	135
2"	50	177.8	15.7	92	152.0	19	4	120.6	200
2.1/2"	65	190.5	17.5	105	178.0	19	4	139.7	250
3"	80	203.2	19.0	127	190.5	19	4	152.4	250
4"	100	228.6	24.0	157	229.0	19	8	190.5	300
5"	125	254.0	24.0	186	254.0	22	8	215.9	350
6"	150	266.7	25.0	216	279.0	22	8	241.3	350
8"	200	292.1	28.5	270	343.0	22	8	298.4	400
10"	250	330.2	30.0	324	406.0	25	12	362.0	450
12"	300	335.6	32.0	381	483.0	25	12	431.8	500
14"	350	381.0	35.0	413	534.0	28	12	476.2	508
16"	400	406.4	36.5	470	597.0	28	16	539.0	508

SIZE	CLASS - 300								
IN	M.M.	A	B	C	D	M	N	P.C.D.	W
1.1/2"	40	190.5	20.5	73	155.4	22	4	114.3	152
2"	50	215.9	22.0	92	166.0	19	8	127.0	203
2.1/2"	65	241.3	25.0	105	190.5	22	8	149.3	203
3"	80	282.5	28.5	127	209.5	22	8	168.1	254
4"	100	304.8	32.0	157	254.0	22	8	200.1	305
5"	125	381.0	35.0	186	279.4	22	8	234.9	356
6"	150	403.2	36.5	216	317.5	22	12	269.7	356
8"	200	419.1	41.0	270	381.0	25	12	330.2	407
10"	250	457.2	48.0	324	444.5	29	16	387.3	457
12"	300	501.6	51.0	381	520.7	32	16	450.8	508
14"	350	762.0	54.0	413	584.2	32	20	514.3	508
16"	400	838.2	57.0	470	647.7	35	20	571.5	508

GLOBE VALVE FLANGE ENDS (150# / 300#)

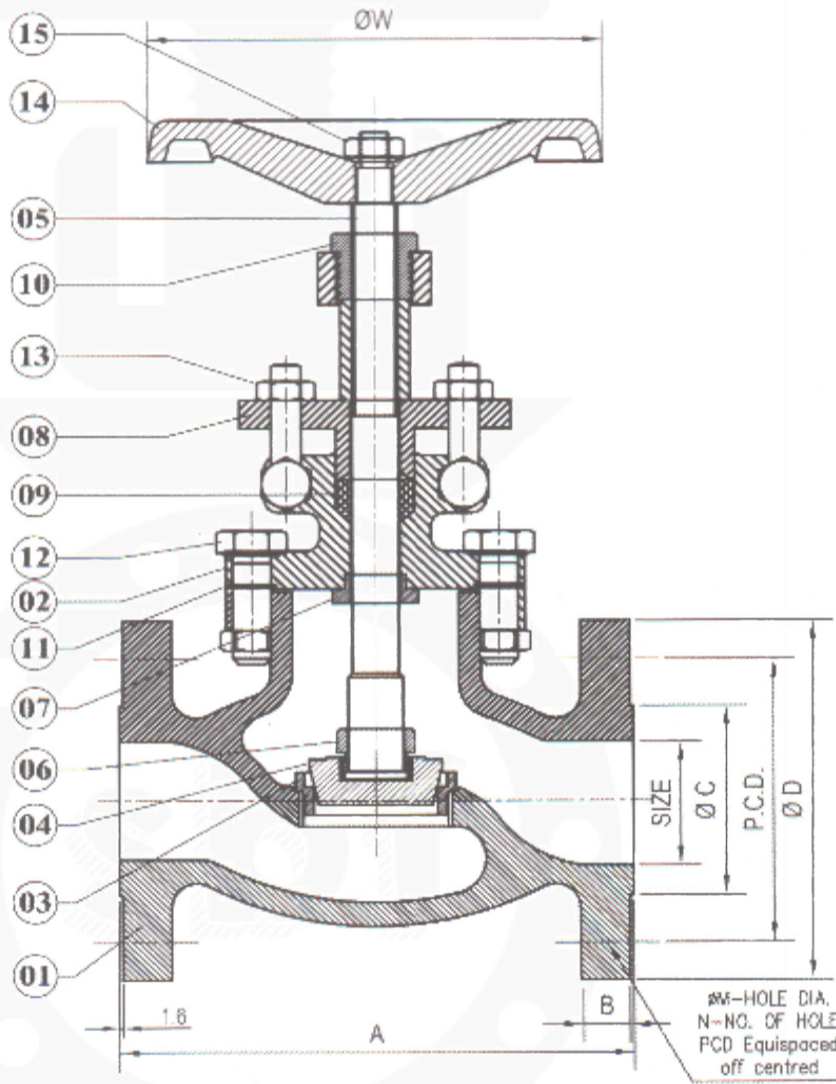

NO	DESCRIPTION	MATERIAL	QTY.
01	BODY	ASTM A216 Gr. WCB/CF8/CF8M	1
02	BONNET	ASTM A216 Gr. WCB/CF8/CF8M	1
03	SEAT RING	AISI 410 (13% CR)/SS 304/ 316	1
04	DISC	AISI 410 (13% CR)/SS 304/ 316	1
05	STEM	AISI 410 (13% CR)/SS 304/ 316	1
06	STEM NUT	AISI 410(13% CR)/SS 304/ 316	1
07	BACK SEAT	AISI 410(13% CR)/SS 304/ 316	1
08	GLAND	CARBON STEEL	1
09	GLAND PACKING	METALIC WIRE REINFORCE GRAPHOIL ASBESTOS	---
10	YOKE SLEEVE	S G IRON	1
11	BONNET GASKET	ASBESTOS FILTER S.S. 304 SPRIAL WOUNDED / CAF	1
12	BONNET STUB & NUT	ASTM A193Gr. B7 / ASTM A 194 Gr. 2H	---
13	EYE BOLT & NUT	ASTM A193Gr. B7 / ASTM A 194 Gr. 2H	1
14	HAND WHEEL	SG IRON	1
15	HAND WHEEL NUT	CARBON STEEL	1

TECHNICAL DATA

DESIGN & MANUFACTURING STD.	BS-1873
TESTING & INSPECTION STD.	AP I 598 /BS 5146
END CONNECTIONS	FLANGED AS PER ANSI B/16.5
SEAL WALL THICKNESS	ANSI B 16.34
FACE TO FACE	AS PER ANSI / B 16.10

PRIMARY SERVICE RATING & TEST PRESSURE

CLASS	WORKING PRESS.	TEMP.	HYD. TEST PRESS	
			BODY	SEAT
150	150 PSID	500 ⁰ F	425 PSIG	300 PSIG
300	300 PSID	800 ⁰ F	1100 PSIG	800 PSIG

AIR TEST - SEAT - 80 PASIG + 10 PSIG

SIZE		CLASS - 150							
IN	M.M.	A	B	C Ø	D Ø	M Ø	N	P.C.D.	W Ø
1"	25	127.0	11.0	51	108.0	16	4	79.2	100
1.1/2"	40	165.1	14.2	73	127.0	16	4	98.5	135
2"	50	177.8	15.7	92	152.0	19	4	120.6	200
2.1/2"	65	190.5	17.5	105	178.0	19	4	139.7	250
3"	80	203.2	19.0	127	190.5	19	4	152.4	250
4"	100	228.6	24.0	157	229.0	19	8	190.5	300
5"	125	254.0	24.0	186	254.0	22	8	215.9	350
6"	150	266.7	25.0	216	279.0	22	8	241.3	350
8"	200	292.1	28.5	270	343.0	22	8	298.4	400
10"	250	330.2	30.0	324	406.0	25	12	362.0	450
12"	300	335.6	32.0	381	483.0	25	12	431.8	500
14"	350	381.0	35.0	413	534.0	28	12	476.2	508
16"	400	406.4	36.5	470	597.0	28	16	539.0	508

SIZE		CLASS - 300							
IN	M.M.	A	B	C Ø	D Ø	M Ø	N	P.C.D.	W Ø
1"	22	203.0	17.5	51	124.0	19	4	89.0	135
1.1/2"	40	229.0	20.5	73	155.5	22	4	114.3	200
2"	50	267.0	22.0	92	165.0	19	8	127.0	200
2.1/2"	65	292.0	25.0	105	190.5	22	8	149.3	200
3"	80	317.5	28.5	127	209.5	22	8	168.0	300
4"	100	356.0	32.0	157	254.0	22	8	200.0	350
5"	125	400.0	35.0	186	279.4	22	8	235.0	350
6"	150	444.5	36.5	216	317.5	22	12	269.7	400
8"	200	559.0	41.0	270	381.0	25	12	330.2	550
10"	250	622.0	47.5	324	444.5	28	16	387.4	600
12"	300	711.0	51.0	381	521.0	32	16	450.8	600

GLOBE VALVE FLANGED ENDS (ND - 40)

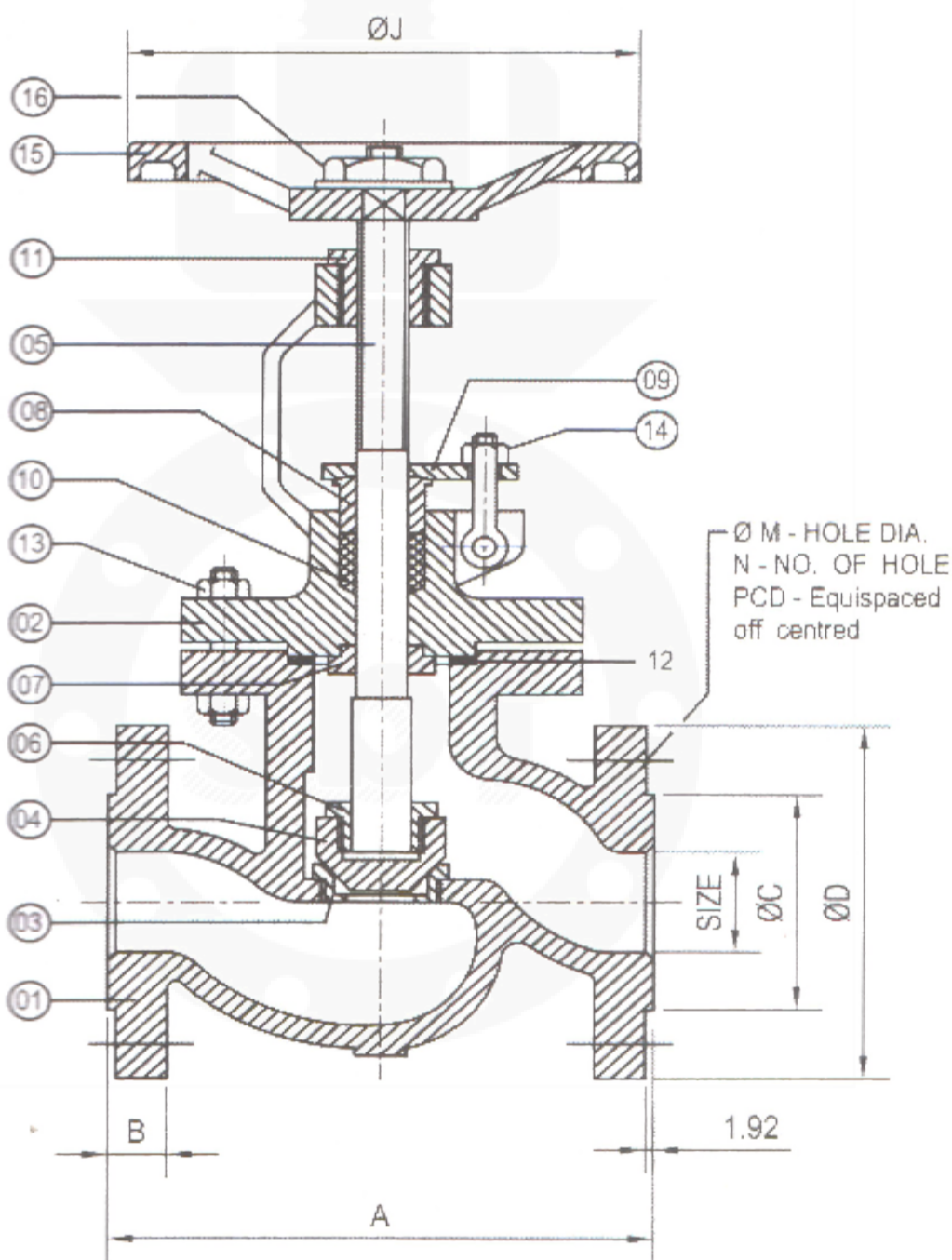

NO	DESCRIPTION	MATERIAL	QTY.
01	BODY	ASTM A216 Gr. WCB/CF8/CF8M	1
02	BONNET	ASTM A216 Gr. WCB/CF8/CF8M	1
03	SEAT RING	AISI 410 (13% CR)/SS 304/ 316	1
04	DISC	AISI 410 (13% CR)/SS 304/ 316	1
05	STEM	AISI 410 (13% CR)/SS 304/ 316	1
06	STEM NUT	AISI 410(13% CR)/SS 304/ 316	1
07	BACK SEAT	AISI 410(13% CR)/SS 304/ 316	1
08	GLAND	CARBON STEEL	1
09	GLAND PACKING	METALIC WIRE REINFORCE GRAPHOIL ASBESTOS	---
10	YOKE SLEEVE	S G IRON	1
11	BONNET GASKET	ASBESTOS FILTER S.S. 304 SPRIAL WOUNDED / CAF	1
12	BONNET STUB & NUT	ASTM A193Gr. B7 / ASTM A 194 Gr. 2H	---
13	EYE BOLT & NUT	ASTM A193Gr. B7 / ASTM A 194 Gr. 2H	1
14	HAND WHEEL	SG IRON	1
15	HAND WHEEL NUT	CARBON STEEL	1

TECHNICAL DATA

DESIGN & MANUFACTURING STD.	BS-1873
TESTING & INSPECTION STD.	AP I 598
END CONNECTIONS	FLANGED AS PER DIN 2533/2543/2535/2545
SEAL WALL THICKNESS	ANSI B 16.34
FACE TO FACE	AS PER DIN ND - 16 / ND - 40

PRIMARY SERVICE RATING & TEST PRESSURE

ND 16	16 kg. / cm ²	220 ⁰ C
300	40kg. / cm ²	400 ⁰ C

HYDRAULIC TEST PRESSURE

STD	BODY	SEAT	AIR
ND 16	32 kg. / cm ²	16kg. / cm ²	6 kg / cm ²
	464 PSIG	232 PSIG	80 PSIG
ND 40	80 kg. / cm ²	40 kg. / cm ²	6 kg. / cm ²
	1160 PSIG	580 PSIG	80 PSIG

SIZE	CLASS - 150								
IN	M.M.	A	B	C Ø	D	M Ø	N	P.C.D.	ØJ
1"	25	160	18	68	115	14	4	85	125
1.1/2"	40	200	20	88	150	18	4	110	175
2"	50	230	20	102	165	18	4	125	175
2.1/2"	65	290	22	122	185	18	8	145	225
3"	80	310	24	138	200	18	8	160	225
4"	100	350	26	162	235	22	8	190	250
5"	125	400	28	188	270	26	8	220	250
6"	150	480	30	218	300	26	8	260	312
8"	200	600	34	285	375	30	12	320	375
10"	250	730	42	345	450	33	12	385	500

SWING TYPE CHECK VALVE (150# / 300#)

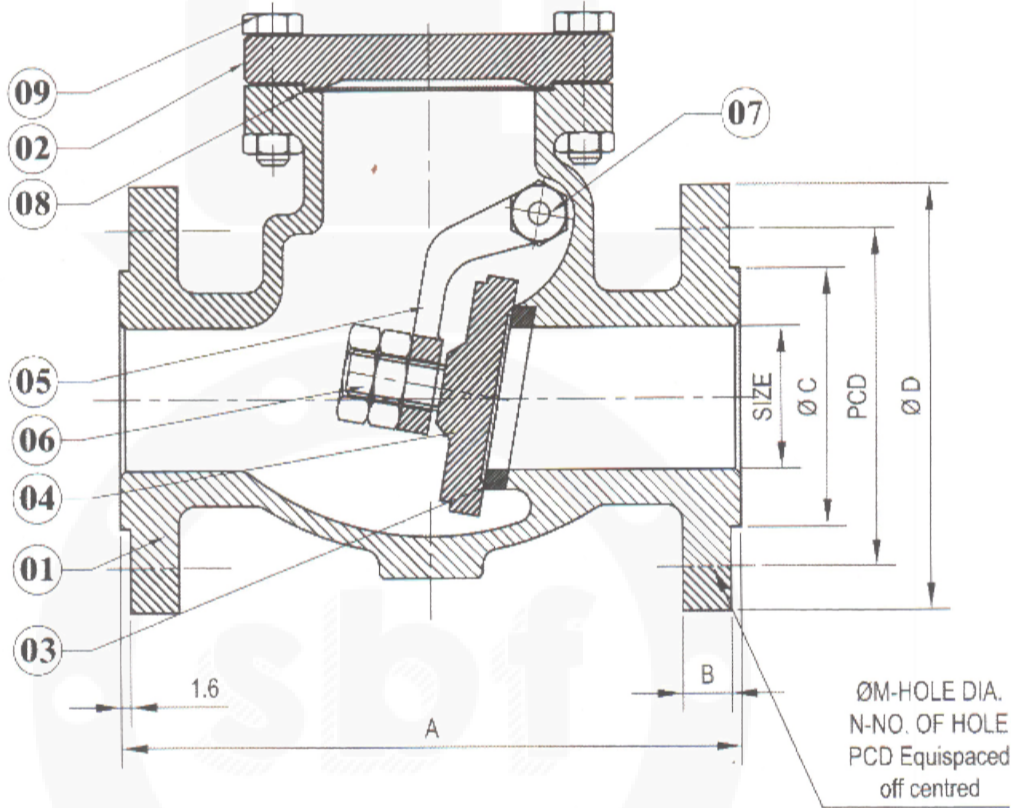

NO	DESCRIPTION	MATERIAL	QTY.
01	BODY	CI / CS / Cf8 / CF8M	1
02	COVER	CI / Cf8 / CF8M	1
03	SEAT RING	SS 410 / SS 304 / SS 316	1
04	DISC	SS 410 / SS 304 / SS 316	1
05	HINGE	SG IRON / SS 304 / SS 316	1
06	DISC NUT	CARBON STEEL	1
07	HINGE PIN	S.S AISI 410	1
08	GASKET	SPRIAL WOUNDED	1
09	COVER STUD & NUT	CARBON STEEL	---

TECHNICAL DATA

DESIGN & MANUFACTURING STD.	ANSI B 16.35 / BS 1868
TESTING & INSPECTION STD.	API 598 / BS 5146
END CONNECTIONS	FLANGED AS PER ANSI B-16.5
SEAL WALL THICKNESS	ANSI B 16.34
FACE TO FACE	AS PER ANSI / B-16.10

PRIMARY SERVICE RATING & TEST PRESSURE

CLASS	WORKING PRESS.	TEMP.	HYD. TEST PRESS	
			BODY	SEAT
150	150 PSID	500 ⁰ F	425 PSIG	300 PSIG
300	300 PSID	800 ⁰ F	1100 PSIG	800 PSIG

SIZE		CLASS - 150						
IN	M.M.	A	B	Ø C	Ø D	Ø M	N	P.C.D.
1.1/2"	40	165	14.2	73	127.0	16	4	98.5
2"	50	203	15.7	92	152.0	19	4	120.6
2.1/2"	65	216	17.5	105	178.0	19	4	139.7
3"	80	241	19.0	127	190.0	19	4	152.4
4"	100	292	24.0	157	229.0	19	8	190.5
5"	125	330	24.0	186	254.0	22	8	215.9
6"	150	356	24.0	216	279.0	22	8	241.3
8"	200	495	28.5	270	343.0	22	8	298.4
10"	250	622	30.0	324	406.0	25	12	362.0
12"	300	699	32.0	381	483.0	25	12	431.8
14"	350	787	35.0	413	533.0	28	12	476.2
16"	400	864	36.5	470	597.0	28	16	539.0

SIZE		CLASS - 300						
IN	M.M.	A	B	Ø C	Ø D	Ø M	N	P.C.D.
1.1/2"	40	241.3	20.5	73	156.0	22	4	114.3
2"	50	266.7	22.0	92	165.0	19	8	127.0
2.1/2"	65	292.0	25.0	105	190.5	22	8	149.3
3"	80	317.0	28.5	127	209.5	22	8	168.0
4"	100	355.0	32.0	157	254.0	22	8	200.0
5"	125	400.0	35.0	186	279.4	22	8	235.0
6"	150	444.5	36.5	216	317.5	22	12	269.7
8"	200	533.4	41.0	270	381.0	25	12	330.2
10"	250	622.3	47.5	324	444.5	28	16	387.4
12"	300	711.2	51.0	381	521.0	32	16	450
14"	350	838.0	54.0	413	584.0	32	20	514.3
16"	400	863.6	57.0	470	648.0	36	20	571.5

"Y" TYPE STRAINER



NO	DESCRIPTION	MATERIAL	QTY.
01	BODY	ASTM A 216 Gr. WCB / CF8 / CF8M	1
02	COVER	ASTM A 216 Gr. WCB / CF8 / CF8M	1
03	SCREEN	SS 304 / SS 316	1
04	COVER STUD & NUT	CARBON STEEL	---
05	GASKET	SPIAL WOUNDED / CAF	1

TECHNICAL DATA

DESIGN & MANUFACTURING STD.	
TESTING & INSPECTION STD.	
END CONNECTIONS	FLANGED AS PER ANSI B-16.5
SEAL WALL THICKNESS	ANSI B 16.34
FACE TO FACE	AS PER ND-40 TYPE /ANSI B-16.10

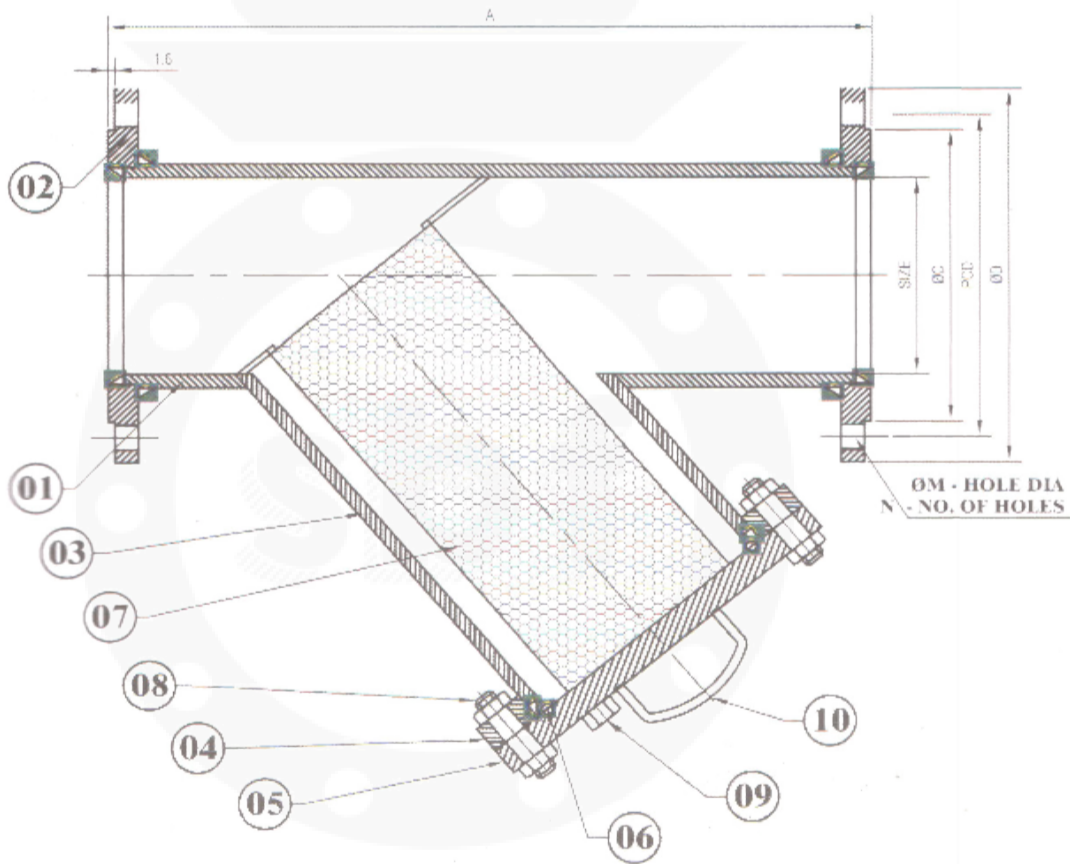

SIZE	ND - 40								
IN	M.M.	N.B	A	B	Ø C	Ø D	Ø M	N	P.C.D.
1"	25	25	160	18	68	115	14	4	85
1.1/2"	40	38	200	18	88	150	18	4	110
2"	50	51	230	20	102	165	18	4	125
2.1/2"	65	64	290	22	122	185	18	8	145
3"	80	76	310	24	138	200	18	8	160
4"	100	102	350	24	162	235	23	8	190
5"	125	126	400	26	180	270	27	8	220
6"	150	152	480	28	218	300	27	8	250

SIZE	CLASS - 300								
IN	M.M.	N.B	A	B	Ø C	Ø D	Ø M	N	P.C.D.
1"	25	25	127	11.0	51	108.0	16	4	79.2
1.1/2"	40	38	165	14.0	43	127.0	16	4	98.5
2"	50	51	203	15.7	92	152.0	19	4	120.6
2.1/2"	65	64	216	17.5	105	178.0	19	4	139.7
3"	80	76	41	19.0	127	190.5	19	4	152.4
4"	100	102	292	24.0	157	229.0	19	8	190.5
5"	125	126	356	24.0	157	254.0	22	8	215.9
6"	150	152	406	25.0	216	279.0	22	8	241.3
8"	200	203	495	28.5	270	343.0	22	8	362.0
10"	250	254	622	30.0	324	406.0	25	12	362.0
12"	300	300	698	32.0	381	483.0	25	12	431.8

3 PC BALL VALVE (150# / 300#)

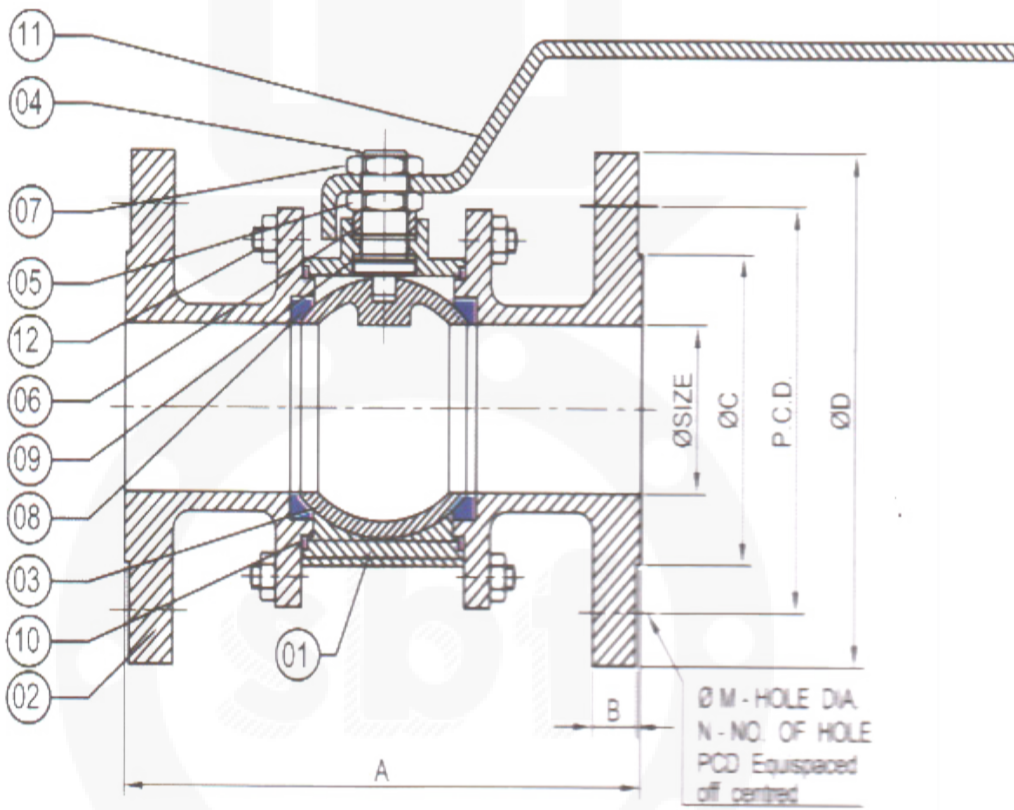
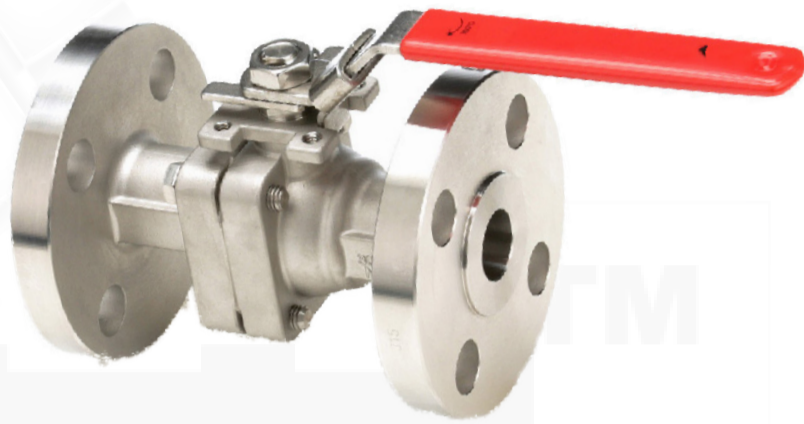

NO	DESCRIPTION	MATERIAL	QTY.
01	BODY	C.S / C.I CF8 / CF8M	1
02	BODY CONNECTOR	C.S / C.I CF8 / CF8M	2
03	BALL	S.S 202 / 304 / 316	1
04	STEM	S.S 202 / 304 / 316	1
05	GLAND NUT	S.S 202 / 304 / 316 / M.S	1
06	GLAND BUSH	S.S 202 / 304 / 316 / M.S	1
07	LOCK NUT	S.S 202 / 304 / 316 / M.S	1
08	SEAT RING	PTFE	---
09	STEAM SEAL	PTFE	
10	BODY SEALENT RING	PTFE	--- 2 SET
11	LEVER	C.S. / S.S 304 / S.S. 316	1
12	STUD & NUT	C.S / S.S.	1

TECHNICAL DATA

DESIGN & MANUFACTURING STD.	BS-5351 / API / 602
TESTING & INSPECTION STD.	AP I 598 / BS 5146
END CONNECTIONS	FLANGED AS PER ANSI B/16.5
SEAL WALL THICKNESS	
FACE TO FACE	AS PER ANSI / B 16.10

PRIMARY SERVICE RATING & TEST PRESSURE

CLASS	WORKING PRESS.	TEMP.	HYD. TEST PRESS	
			BODY	SEAT
150	150 PSID	180° F	425 PSIG	300 PSIG
300	300 PSID	180° F	1100 PSIG	800 PSIG

SIZE		CLASS - 150						
IN	M.M.	A	B	Ø C	Ø D	Ø M	N	P.C.D.
1/2"	15	108	10	35	89	16	4	60.4
3/4"	20	118	10.	43	98	16	4	69.8
1"	25	127	11	51	108	16	4	79.2
1.1/4"	32	140	12.7	65	117	16	4	88.9
1.1/2"	40	165	14.2	73	127	16	4	98.5
2"	50	178	15.7	92	152	19	4	120.6
2.1/2"	65	191	17.5	105	178	19	4	139.7
3"	80	203	19	127	190.5	19	4	152.4
4"	100	229	24	157	229	19	8	190.5
5"	125	254	24	186	254	22	8	215.9
6"	150	267	25.5	216	279	22	8	241.3
8"	200	292	29.0	270	343	22	8	298.4

SIZE		CLASS - 300						
IN	M.M.	A	B	Ø C	Ø D	Ø M	N	P.C.D.
1/2"	15	140	14.2	32	95	16	4	66.5
3/4"	20	152	15.7	43	117	19	4	82.5
1"	25	165	17.5	51	124	19	4	88.9
1.1/2"	40	190.5	20.5	73	155.5	22	4	114.3
2"	50	216	22	92	165	19	8	127
2.1/2"	65	241	25	105	190.5	22	8	149.3
3"	80	282.5	28.5	127	209.5	22	8	168
4"	100	305	32	157	254	22	8	200

2 PC BALL VALVE (150# / 300#)

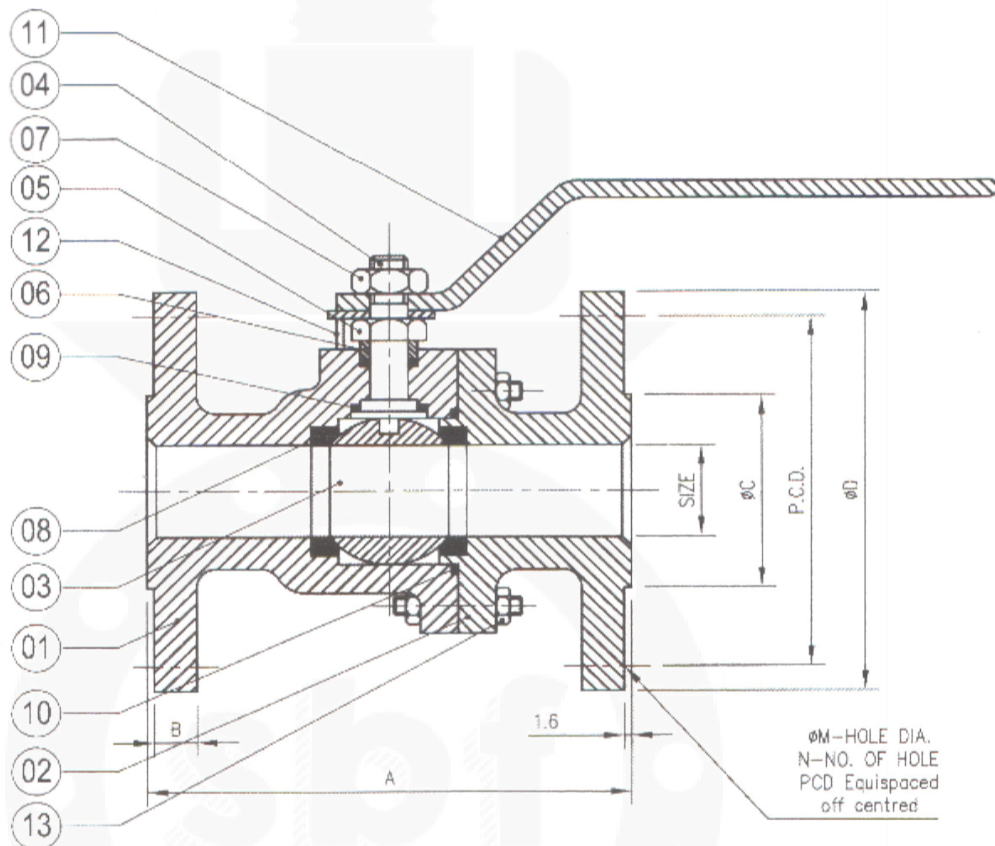

NO	DESCRIPTION	MATERIAL	QTY.
01	BODY	C.S / C.f8 / CF8M	1
02	BODY CONNECTOR	C.S / CF8 / CF8M	2
03	BALL	S.S 202 / 304 / 3016	1
04	STEM	S.S 202 / 304 / 316	1
05	GLAND NUT	S.S 202 / 304 / 316 / M.S	1
06	GLAND BUSH	S.S 202 / 304 / 316 / M.S	1
07	LOCK NUT	S.S 202 / 304 / 316 / M.S	1
08	SEAT RING	PTFE	---
09	STEAM SEAL	PTFE	
10	BODY SEALENT RING	PTFE	--- 2 SET
11	LEVER	M.S. / S.S 304 / S.S. 316	1
12	STOPPER PIN	M.S. / S.S 304 / S.S. 316	1
13	STUD & NUT	M.S / S.S.	

TECHNICAL DATA

DESIGN & MANUFACTURING STD.	BS-5351 / API / 602
TESTING & INSPECTION STD.	AP I 598 / BS 5146
END CONNECTIONS	FLANGED AS PER ANSI B/16.5
SEAL WALL THICKNESS	
FACE TO FACE	AS PER ANSI / B 16.10

PRIMARY SERVICE RATING & TEST PRESSURE

CLASS	WORKING PRESS.	TEMP.	HYD. TEST PRESS	
			BODY	SEAT
150	150 PSID	180° F	425 PSIG	300 PSIG
300	300 PSID	200° F	1100 PSIG	800 PSIG

SIZE		CLASS - 150						
IN	M.M.	A	B	ø C	ø D	ø M	N	P.C.D.
1/2"	15	108	10	35	89	16	4	60.4
3/4"	20	118	10.	43	98	16	4	69.8
1"	25	127	11	51	108	16	4	79.2
1.1/4"	32	140	12.7	65	117	16	4	88.9
1.1/2"	40	165	14.2	73	127	16	4	98.5
2"	50	178	15.7	92	152	19	4	120.6
2.1/2"	65	191	17.5	105	178	19	4	139.7
3"	80	203	19	127	190.5	19	4	152.4
4"	100	229	24	157	229	19	8	190.5
5"	125	254	24	186	254	22	8	215.9
6"	150	267	25.5	216	279	22	8	241.3
8"	200	292	29.0	270	343	22	8	298.4
10"	250	330	30.0	324	406.0	25	12	362.0

SIZE		CLASS - 300						
IN	M.M.	A	B	ø C	ø D	ø M	N	P.C.D.
1"	25	165.0	17.5	51	124.0	19	4	88.9
1.1/2"	40	190.5	20.5	73	155.5	22	4	114.3
2"	50	216.0	22.0	92	165.0	19	8	127.0
2.1/2"	65	241.0	25.0	105	190.5	22	8	149.3
3"	80	282.5	28.5	127	209.5	22	8	168.0
4"	100	305.0	32.0	157	254.0	22	8	200.0
5"	125	381.0	35.0	186	279.4	22	8	235.0
6"	150	403.0	36.5	216	317.5	22	12	269.7
8"	200	419.0	41.0	270	381.0	25	12	330.2
10"	250	457.0	47.5	324	444.5	28	16	387.4

BUTTER FLY VALVE 40mm To 200mm



NO	DESCRIPTION	MATERIAL	QTY.
01	BODY	CAST IRON, CAST STEEL / SS 304-316	1
02	DISC	CI / SG IRON/ CAST STEEL / SS 304-316	1
03	SPINDLE	SS 410 / 304 / 316	1
04	BODY LINING	NITRILE / EPDM / SILICON / VITON / HYPALON	-
05	"O" RING	NITRILE / EPDM	1
06	PIN	SS 304 / 316	1
07	LEVER	MS FABRICATED	1

TECHNICAL DATA

DESIGN & MANUFACTURING STD.	BS-5155 / API 609 / EN 593 / IS 13095
FACE TO FACE DIMENSION	BS 5155 / ISO 5792 / API 609
TOP FLANGE DRILLING	ISO 5211
INSPECTION & TESTING	BS 6755 PART -1 / API 598 / EN 1266-1
FLANGE STANDARD CONFIRMITY	ANSI 150 / ANSI 125 / BS 10 TAB D & E

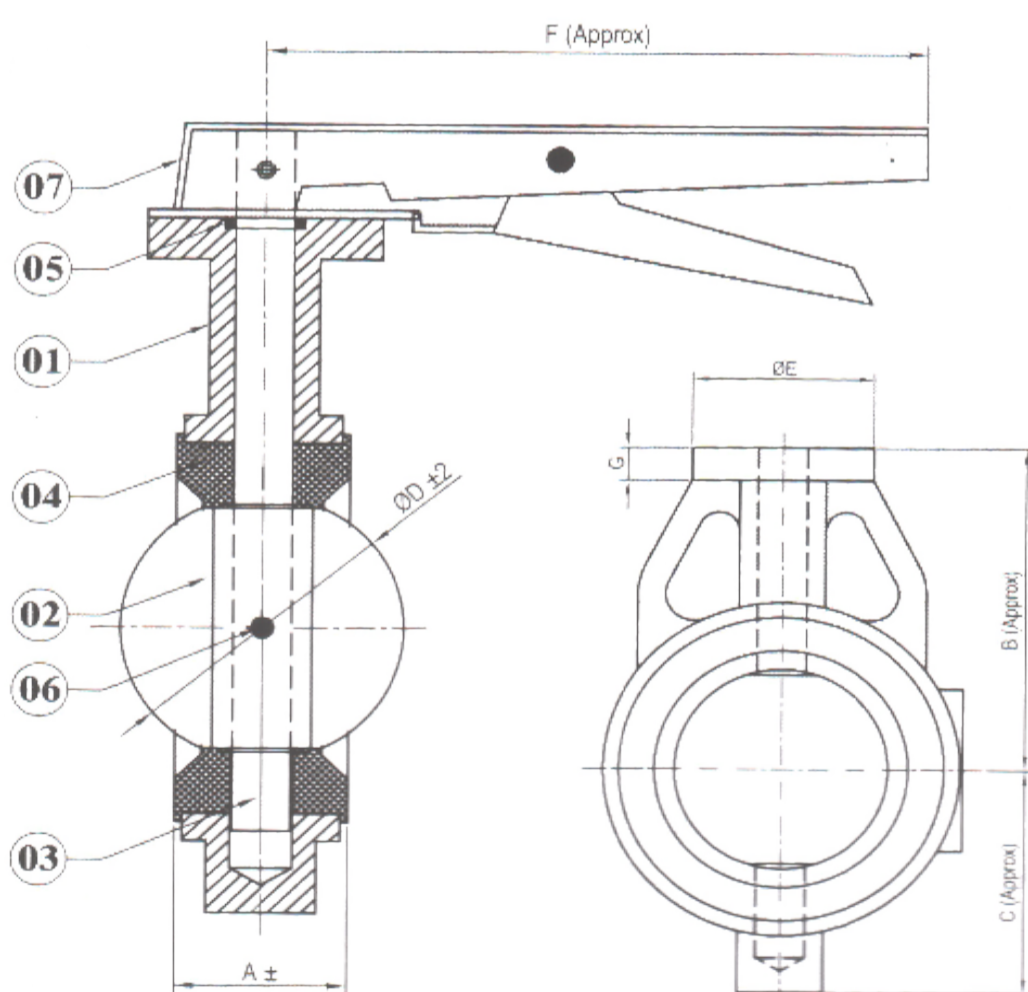

SEAT TYPE	TEMPERATURE RANGE	
	MINIMUM	MAXIMUM
NITRILE	-13° F (-25° C)	212° F (100° C)
EPDM	-13° F (-25° C)	250° F (-25° C)
SILICON	-58° F (-50° C)	356° F (-180° C)
VITON	-23° F (-5° C)	392° F (-200° C)
HYPALON	-4° F (-20° C)	250° F (-120° C)

PRESSURE RATING	HYDROSTATIC SHELL TEST		HYDROSTATIC SHELL TEST	
	KG / CM2	PSIG	KG / CM2	PSIG
PN 16	22	310	16	225
PN 10	15	210	10	140

SIZE									TOP FLANGE MOUNTING (ISO 5211)
IN	M.M	A	B	C	D	E	F	G	
1.1/2	40	36	92	52	40	65	180	15	F 05
2"	50	43	103	70	50	65	180	15	F 05
2.1/2"	65	46	110	76	63	65	180	15	F 05
3"	80	46	118	85	76	65	215	15	F 05
4"	100	52	148	102	100	65	215	15	F 05
5"	125	56	164	115	125	65	215	15	F 05
6"	150	56	176	130	150	65	265	15	F 05
8"	200	60	230	156	200	75	325	15	F 07

BUTTERFLY VALVE 200mm To 450mm

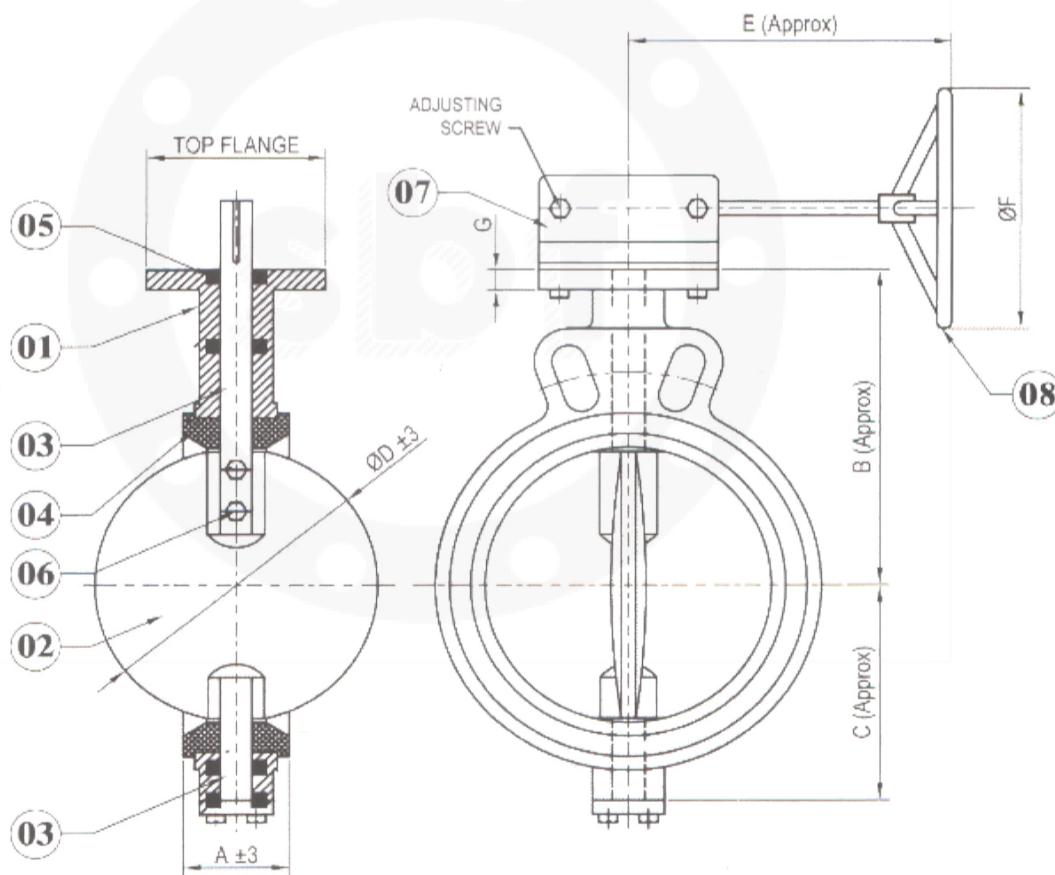

NO	DESCRIPTION	MATERIAL	QTY.
01	BODY	CAST IRON. CAST STEEL / SS 304-316	1
02	DISC	CI / SG IRON/ CAST STEEL / SS 304-316	1
03	SPINDLE	SS 410 / 304 / 316	1
04	BODY LINING	NITRILE / EPDM / SILICON / VITON / HYPALON	-
05	"O" RING	NITRILE / EPDM	1
06	PIN	SS 304 / 316	1
07	GEAR BOX	CAST IRON	1
08	HAND WHEEL	MS FABRICATED	1

TECHNICAL DATA	
DESIGN & MANUFACTURING STD.	BS-5155 / API 609 / EN 593 / IS 13095
FACE TO FACE DIMENSION	BS 5155 / ISO 5792 / API 609
TOP FLANGE DRILLING	ISO 5211
INSPECTION & TESTING	BS 6755 PART -1 / API 598 / EN 1266-1
FLANGE STANDARD CONFIRMITY	ANSI 150 / ANSI 125 / BS 10 TAB D & E IS 6392 NP 0.6 / 1.0 / 1.6

SEAT TYPE	TEMPERATURE RANGE	
	MINIMUM	MAXIMUM
NITRILE	-13° F (-25° C)	212° F (100° C)
EPDM	-13° F (-25° C)	250° F (-25° C)
SILICON	-58° F (-50° C)	356° F (-180° C)
VITON	-23° F (-5° C)	392° F (-200° C)
HYPALON	-4° F (-20° C)	250° F (-120° C)

PRESSURE RATING	HYDROSTATIC SHELL TEST		HYDROSTATIC SHELL TEST	
	KG / CM ²	PSIG	KG / CM ²	PSIG
PN 16	22	310	16	225
PN 10	15	210	10	140

SIZE									
IN	M.M	A	B	C	D	E	F	G	TOP FLANGE MOUNTING (ISO 5211)
8"	200	60	230	156	200	285	300	15	F 10
10"	250	68	266	196	250	285	350	18	F 10
12"	300	78	300	230	298	285	350	18	F 12
14"	350	92	320	272	348	300	350	22	F 12
16"	400	102	385	302	394	305	500	22	F 14
18"	450	114	405	325	433	305	500	24	F 14

BUTTERFLY VALVE 500mm To 900mm

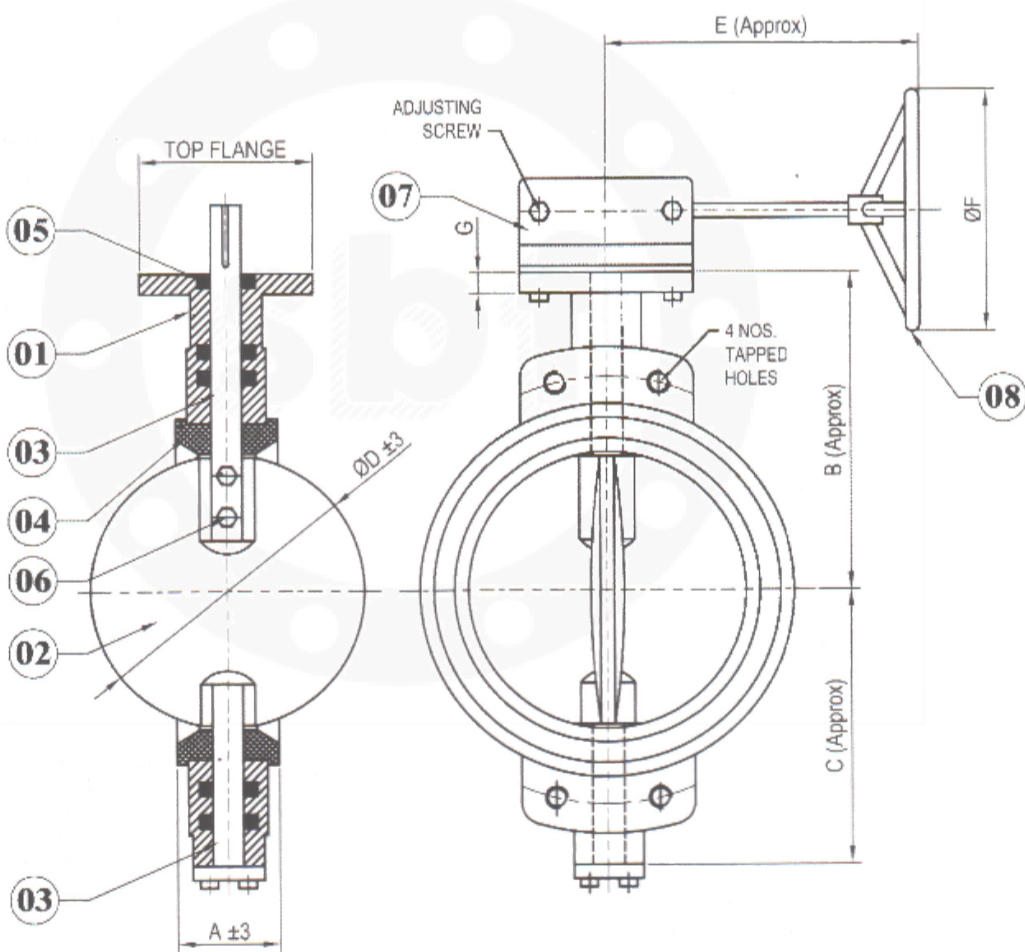

NO	DESCRIPTION	MATERIAL	QTY.
01	BODY	CAST IRON. CAST STEEL / SS 304-316	1
02	DISC	CI / SG IRON/ CAST STEEL / SS 304-316	1
03	SPINDLE	SS 410 / 304 / 316	1
04	BODY LINING	NITRILE / EPDM / SILICON / VITON / HYPALON	-
05	"O" RING	NITRILE / EPDM	1
06	PIN	SS 304 / 316	1
07	GEAR BOX	CAST IRON	1
08	HAND WHEEL	MS FABRICATED	1

TECHNICAL DATA	
DESIGN & MANUFACTURING STD.	BS-5155 / API 609 / EN 593 / IS 13095
FACE TO FACE DIMENSION	BS 5155 / ISO 5792 / API 609
TOP FLANGE DRILLING	ISO 5211
INSPECTION & TESTING	BS 6755 PART -1 / API 598 / EN 1266-1
FLANGE STANDARD CONFIRMITY	ANSI 150 / ANSI 125 / BS 10 TAB D & E IS 6392 NP 0.6 / 1.0 / 1.6

SEAT TYPE	TEMPERATURE RANGE	
	MINIMUM	MAXIMUM
NITRILE	-13° F (-25° C)	212° F (100° C)
EPDM	-13° F (-25° C)	250° F (-25° C)
SILICON	-58° F (-50° C)	356° F (-180° C)
VITON	-23° F (-5° C)	392° F (-200° C)
HYPALON	-4° F (-20° C)	250° F (-120° C)

PRESSURE RATING	HYDROSTATIC SHELL TEST		HYDROSTATIC SHELL TEST	
	KG / CM ²	PSIG	KG / CM ²	PSIG
PN 16	22	310	16	225
PN 10	15	210	10	140

SIZE									TOP FLANGE MOUNTING (ISO 5211)
IN	M.M	A	B	C	D	E	F	G	
20"	500	127	465	405	470	370	500	26	F 16
22"	550	127	490	415	525	370	500	16	F 16
24"	600	154	540	460	570	350	600	26	F 16
28"	700	229	565	515	660	380	600	28	F 16
30"	750	229	590	540	740	380	600	28	F 25
32"	800	241	588	650	760	396	600	28	F 25
36"	900	241	720	660	890	396	600	28	F 25

FABRICATED BASKET TYPE STRAINER

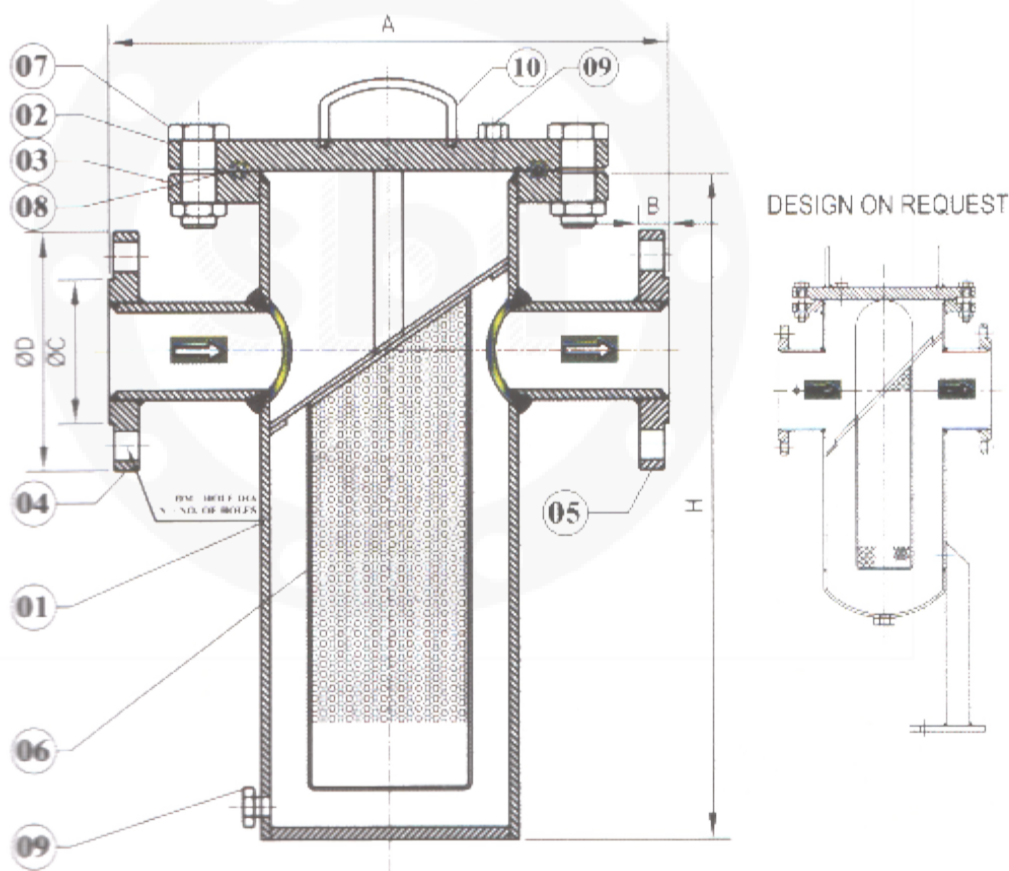
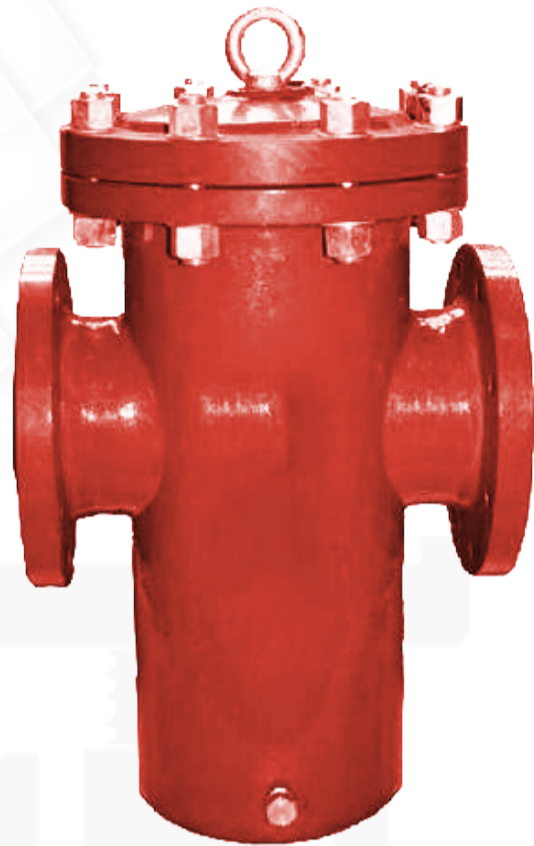

NO	DESCRIPTION	MATERIAL	QTY.
01	BODY	C.S / Cf8 / CF8M	1
02	BODY CONNECTOR	C.S / CF8 / CF8M	2
03	BALL	S.S 202 / 304 / 3016	1
04	STEM	S.S 202 / 304 / 316	1
05	GLAND NUT	S.S 202 / 304 / 316 / M.S	1
06	GLAND BUSH	S.S 202 / 304 / 316 / M.S	1
07	LOCK NUT	S.S 202 / 304 / 316 / M.S	1
08	SEAT RING	PTFE	---
09	STEAM SEAL	PTFE	
10	BODY SEALENT RING	PTFE	--- 2 SET
11	LEVER	M.S. / S.S 304 / S.S. 316	1
12	STOPPER PIN	M.S. / S.S 304 / S.S. 316	1
13	STUD & NUT	M.S / S.S.	

TECHNICAL DATA

DESIGN & MANUFACTURING STD.	MANUFACTURING
TESTING & INSPECTION STD.	
END CONNECTIONS	FLANGED AS PER ANSI B 16.5 - 150#
SEAL WALL THICKNESS	AS PER PIPE STANDARD
FACE TO FACE	AS PER ANSI / B 16.10 SHOWN

PRIMARY SERVICE RATING & TEST PRESSURE

CLASS	WORKING PRESS.	TEMP.	HYD. TEST PRESS	
			BODY	SEAT
150			225 PSIG	150 PSIG

SIZE

CLASS - 150

M.M	INCH	A	H	B	C	D	M	N	P.C.D
25	1"	200	300	11	51	108	16	4	79
40	1.1/2"	260	330	14	73	127	16	4	98.5
50	2"	260	335	16	92	152	19	4	120.5
65	2.1/2"	260	350	17.5	105	178	19	4	140
80	3"	300	365	19	127	190.5	19	4	152.4
100	4"	330	420	24	157	229	19	8	190.5
125	5"	400	455	24	186	255	19	8	216
150	6"	400	480	25	216	279	22	8	241
200	8"	465	620	28.5	270	343	22	8	298.4
250	10"	515	770	30	324	406	25	12	362
300	12"	575	940	32	381	483	25	12	432
350	14"	680	1040	35	412.7	533.4	28.6	12	476.2
400	16"	750	1085	36.5	469.9	596.9	28.6	16	539.7
450	18"	850	1200	40	533.4	635.0	31.7	16	577.8
500	20"	1000	1300	43	584.2	398.5	31.7	20	635.0
600	24"	1200	1400	47.6	692.1	812.8	34.9	20	749.3

FABRICATED "POT" TYPE STRAINER

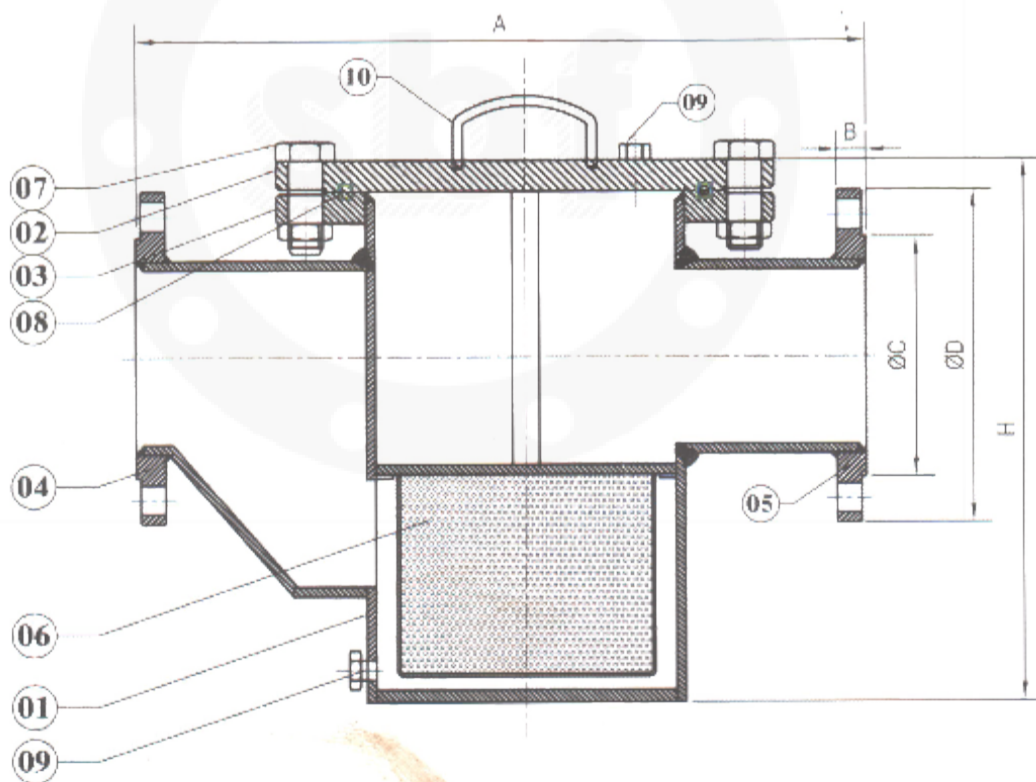

NO	DESCRIPTION	MATERIAL	QTY.
01	BODY	IS 2062	1
02	TOP COVER	IS 2062	1
03	BODY COVER	IS 2062	1
04	INLET FLANGE	IS 2062	1
05	OUTLET FLANGE	IS 2062	1
06	SCREEN	SS 304 (40 MESH)	1
07	COVER BOLT & NUT	CARBON STEEL	--
08	GASKET	NITRILE	1
09	DRAIN PLUG & VENT PLUG	ASTMA A 105	1
10	LIFTING HANDLE	CARBON STEEL	1

TECHNICAL DATA

DESIGN & MANUFACTURING STD.	AS PER PIPE MANUFACTOR STD.
TESTING & INSPECTION STD.	
END CONNECTIONS	FLANGED AS PER ANSI B 16.5 - 150#
SEAL WALL THICKNESS	AS PER PIPE STANDARD
FACE TO FACE	AS PER MANUFACTURER STD

PRIMARY SERVICE RATING & TEST PRESSURE

CLASS	WORKING PRESS.	TEMP.	HYD. TEST PRESS	
			BODY	SEAT
150			225 PSIG	150 PSIG

SIZE CLASS - 150

SIZE	CLASS - 150								
M.M	INCH	A	H	B	C	D	M	N	P.C.D
25	1"	250	250	11	51	108	16	4	79
40	1.1/2"	310	290	14	73	127	16	4	98.5
50	2"	310	300	16	92	152	19	4	120.5
65	2.1/2"	310	300	17.5	105	178	19	4	140
80	3"	350	315	19	127	190.5	19	4	152.4
100	4"	380	350	24	157	229	19	8	190.5
125	5"	450	400	24	186	255	19	8	216
150	6"	450	425	25	216	279	22	8	241
200	8"	515	550	28.5	270	343	22	8	298.4
250	10"	600	700	30	324	406	25	12	362
300	12"	700	850	32	381	483	25	12	432
350	14"	800	900	35	412.7	533.4	28.6	12	476.2
400	16"	900	1000	36.5	469.9	596.9	28.6	16	539.7
450	18"	1000	1100	40	533.4	635.0	31.7	16	577.8
500	20"	1100	1200	43	584.2	698.5	31.7	20	635.0
600	24"	1300	1300	47.6	692.1	812.8	34.9	20	749.3

FABRICATED 'Y' TYPE STRAINER



NO	DESCRIPTION	MATERIAL	QTY.
01	MAIN PIPE	IS 2062	1
02	SIDE FLANGE	IS 2062	2
03	PIPE	IS 2062	1
04	TOP FLANGE	IS 2062	1
05	TOP COVER	IS 2062	1
06	GASKET	NITRILE	1
07	SCREEN	S.S. 304	1
08	COVER STUD & NUT	CARBON STEEL	---
09	DRAIN PLUG	ASTMA A 105	1
10	LIFTING HANDLE	CARBON STEEL	1

TECHNICAL DATA

DESIGN & MANUFACTURING STD.	ASME B 16.34
END CONNECTIONS	FLANGED AS PER ANSI B 16.5 - 150#
SEAL WALL THICKNESS	AS PER PIPE STANDARD
FACE TO FACE	AS PER ANSI / B 16.10

PRIMARY SERVICE RATING & TEST PRESSURE

CLASS - 150	HYD. TEST PRESSURE	SERVICE RATING
BODY	10 Kg. / CM2	

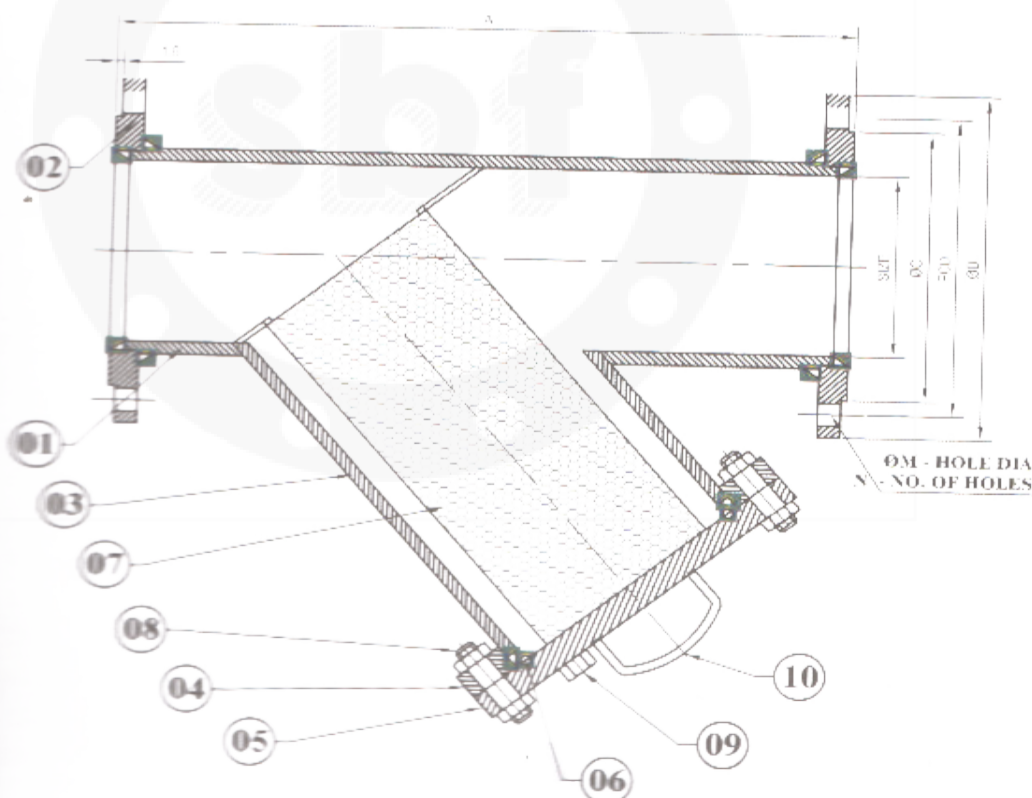

SIZE		CLASS - 150						
M.M	INCH	A	B	C	D	M	N	P.C.D
25	1"	160	11	51	108	16	4	79
40	1.1/2"	200	14	73	127	16	4	98.5
50	2"	230	16	92	152	19	4	120.5
65	2.1/2"	290	17.5	105	178	19	4	140
80	3"	310	19	127	190.5	19	4	152.4
100	4"	350	24	157	229	19	8	190.5
125	5"	400	24	186	255	19	8	216
150	6"	480	25	216	279	22	8	241
200	8"	600	28.5	270	343	22	8	298.4
250	10"	730	30	324	406	25	12	362
300	12"	850	32	381	483	25	12	432
350	14"	980	35	412.7	533.4	28.6	12	476.2
400	16"	1100	36.5	469.9	596.9	28.6	16	539.7
450	18"	1200	40	533.4	635.0	31.7	16	577.8
500	20"	1250	43	584.2	698.5	31.7	20	635.0
600	24"	1450	47.6	692.1	812.8	34.9	20	749.3

WAFER TYPE CHECK VALVE

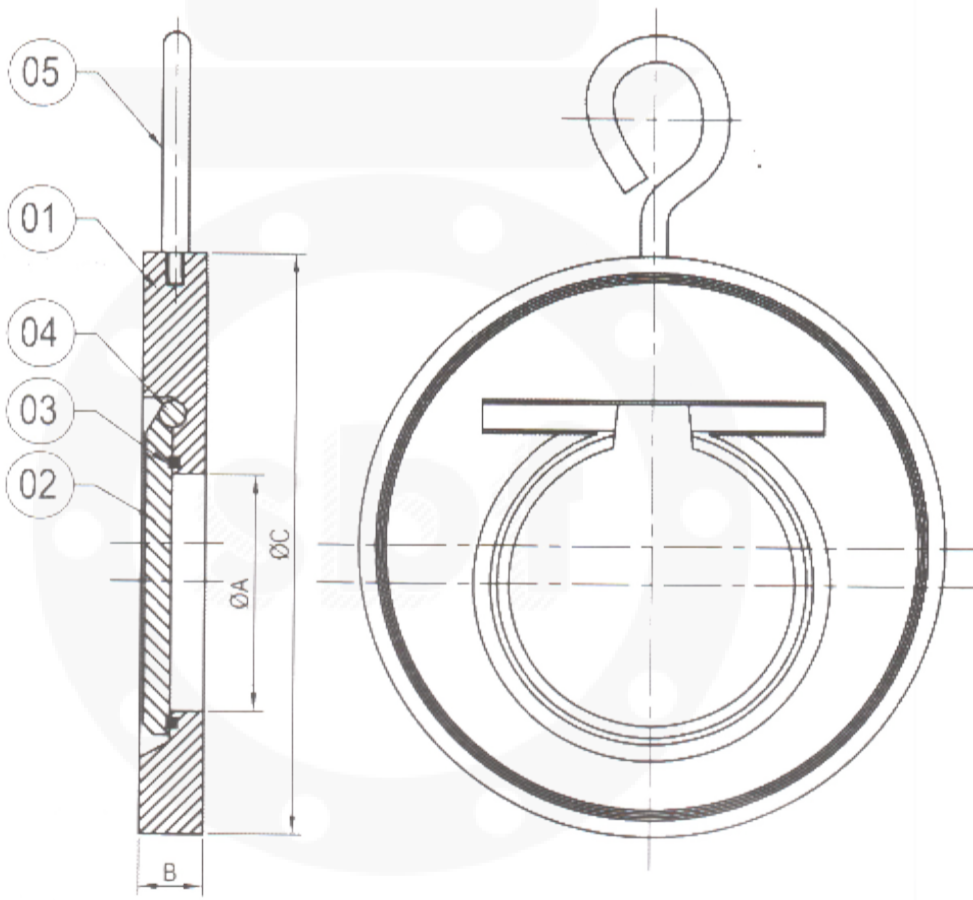

NO	DESCRIPTION	MATERIAL	QTY.
01	BODY	C.I / M.S. / Cf8 / CF8M / Cf3 / Cf3M	1
02	DISC	C.I / M.S. / Cf8 / CF8M / Cf3 / Cf3M	
03	'O' RING	NITRILE , EPDM , VTION	1
		SILICON, PTEE	
04	HINGE PIN	AISI 304,316,M.S	1
05	LIFTING HOOK	M.S. / S.S.	1

TECHNICAL DATA	
DESIGN & MANUFACTURING STD.	API 60 / ANSI B 16.34
TESTING & INSPECTION STD.	API 598
PRESSURE CLASS	150#

PRIMARY SERVICE RATING & TEST PRESSURE				
CLASS	WORKING PRESSURE	TEMP.	HYD. TEST PRES SURE	
			BODY	SEAT
150#	20° F TO 180°F		225 PSIG	150 PSIG

SIZE		DIMENSION		
M.M	INCH	A	B	C
25	1"	14	16	64
40	1.1/2"	22	19	86
50	2"	30	19	104
104	2.1/2"	40	19	123
80	3"	52	19	136
100	4"	71	19	174
125	5"	93	19	196
150	6"	114	19	221
200	8"	157	28	278
250	10"	195	28	339
300	12"	230	38	409
350	14"	270	44	449
400	16"	310	50	512
450	18"	360	60	545
500	20"	406	63	605
600	24"	490	70	714

DISC TYPE CHECK VALVE

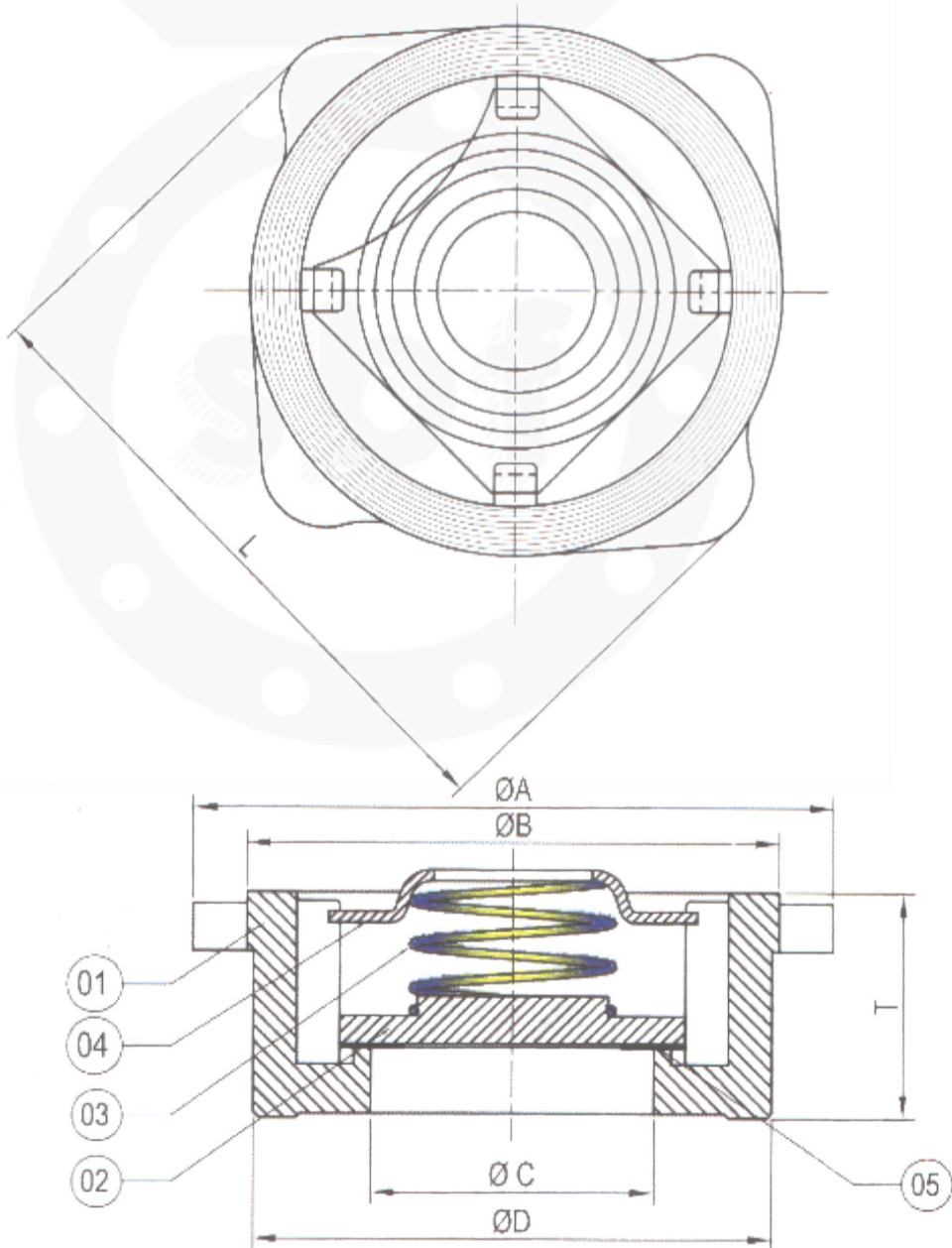

NO	DESCRIPTION	MATERIAL	QTY.
01	BODY	ASTM A 351 Gr. Cf8 / CF8M	1
02	DISC	AISI 304,316,M.S	1
03	SPRING	AISI 304,316,M.S	1
04	COVER PLATE	AISI 304,316,M.S	1
05	DISC SEAT	METAL TO METAL	1

TECHNICAL DATA	
DESIGN & MANUFACTURING STD.	BS 7438
TESTING & INSPECTION STD.	
RATING	PN 40

PRIMARY SERVICE RATING & TEST PRESSURE			
CLASS	WORKING PRESSURE	TEMP.	
	PN 40	3000C	
AIR TEST - SEAT 80 PSIG + 10 PSIG			

SIZE		DIMENSION					
M.M	INCH	A	B	C	D	T	L
15	1/2"	43	29	15	38	16	60
20	3/4"	53	36	20	45	19	70
25	1"	63	44	25	56	22	80
73	1.1/4"	55	32	65	28	90	46
40	1.1/2"	83	66	40	74	31	98
50	2"	93	77	50	85	40	112
65	2.1/2"	114	98	65	107	46	141
80	3"	132	111	80	122	50	151
100	4"	153	130	100	142	60	181
125	5"	185	161	125	170	90	215
150	6"	212	190	150	202	105	255
200	8"	277	250	200	261	140	320

DUAL PLATE CHECK VALVE (150#)

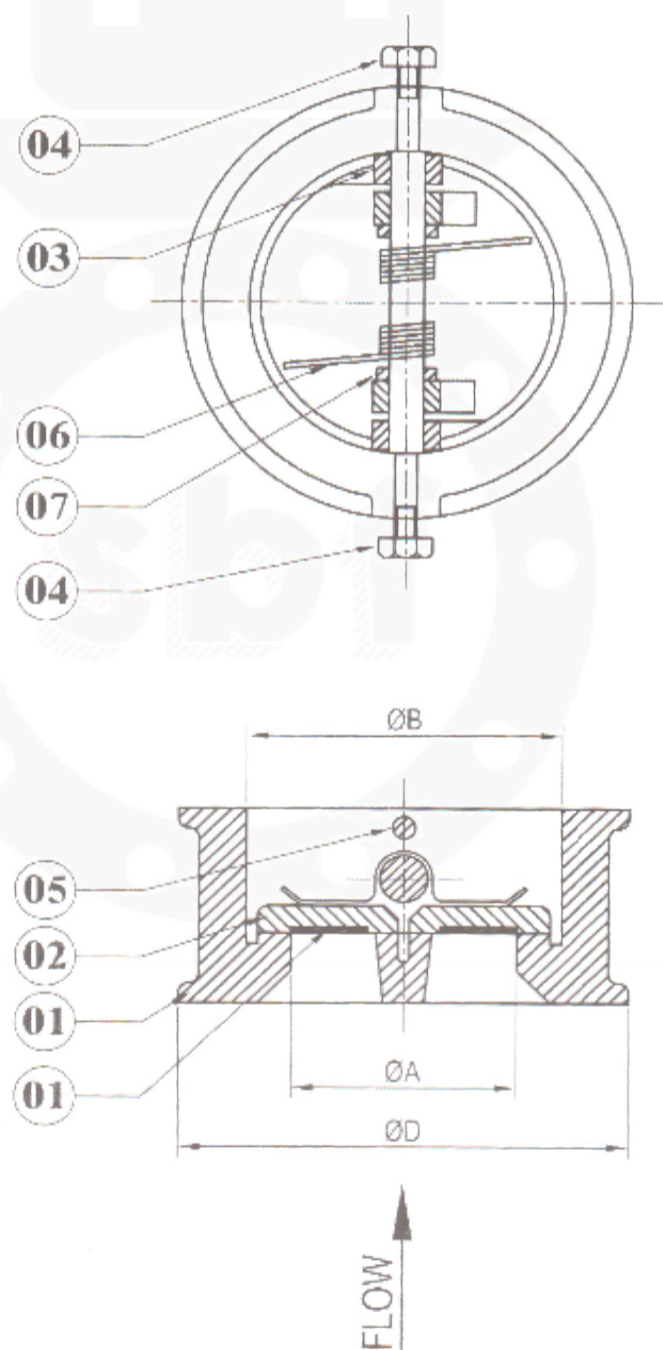

NO	DESCRIPTION	MATERIAL	QTY.
01	BODY	C.I. - IS-210 GR. FG 200/ ASTM A 216 GR. WCB	1
02	DISC	A 351 GR. CF8	2
03	HINGE PIN	AISI 304 / AISI 316	1
04	PLUG	AISI 304 / AISI 316	2
05	STOP PIN	AISI 304 / AISI 316	1
06	SPRING	AISI 304 / AISI 316	2
07	BEARING	AISI 304 / AISI 316	1
08	SEAT	NBR,EPDM,VITON	1

TECHNICAL DATA	
DESIGN & MANUFACTURING STD.	API 594
TESTING & INSPECTION STD.	API 598
END CONNECTIONS	WAFER TYPE SUIT TO ANSI B 16.5
FACE TO FACE	API 594

PRIMARY SERVICE RATING & TEST PRESSURE				
CLASS	WORKING PRESSURE	TEMP.	HYP. TEST PRESSURE	
			BODY	SEAT
150	20°F TO 180°F		21 PSIG	11 PSIG

SIZE		DIMENSION		
M.M	INCH	A	B	D
50	2"	50	60	105
65	2.1/2"	65	75	124
80	3"	75	90	134
100	4"	100	115	172
125	5"	125	135	196
150	6"	150	165	220
200	8"	200	220	276
250	10"	250	265	338
300	12"	300	320	407
350	14"	350	350	448
400	16"	400	400	549
450	18"	450	450	549
500	20"	500	500	603
600	24"	600	600	718

THERMODYNAMIC (TD-3) STEAM TRAP



NO	DESCRIPTION	MATERIAL	QTY.
01	BODY	IC 410	1
02	SCREEN	S.S 304	1
03	PLUG	IC 410	1
04	DISC	S.S. 410	1
05	BODY COVER	IC 410	1

TECHNICAL DATA	
DESIGN & MANUFACTURING STD.	
TESTING & INSPECTION STD.	
END CONNECTIONS	ANSI B 1.20.1
FACE TO FACE	ANSI B 16.11

SIZE				
M.M	INCH	A	THDS.	C
15	1/2"	79	1/2" BSP/BSPT/NPT	22.0
20	3/4"	79	3/4" BSP/BSPT/NPT	27.5
92	1"	92	1" BSP/BSPT/NPT	34.0

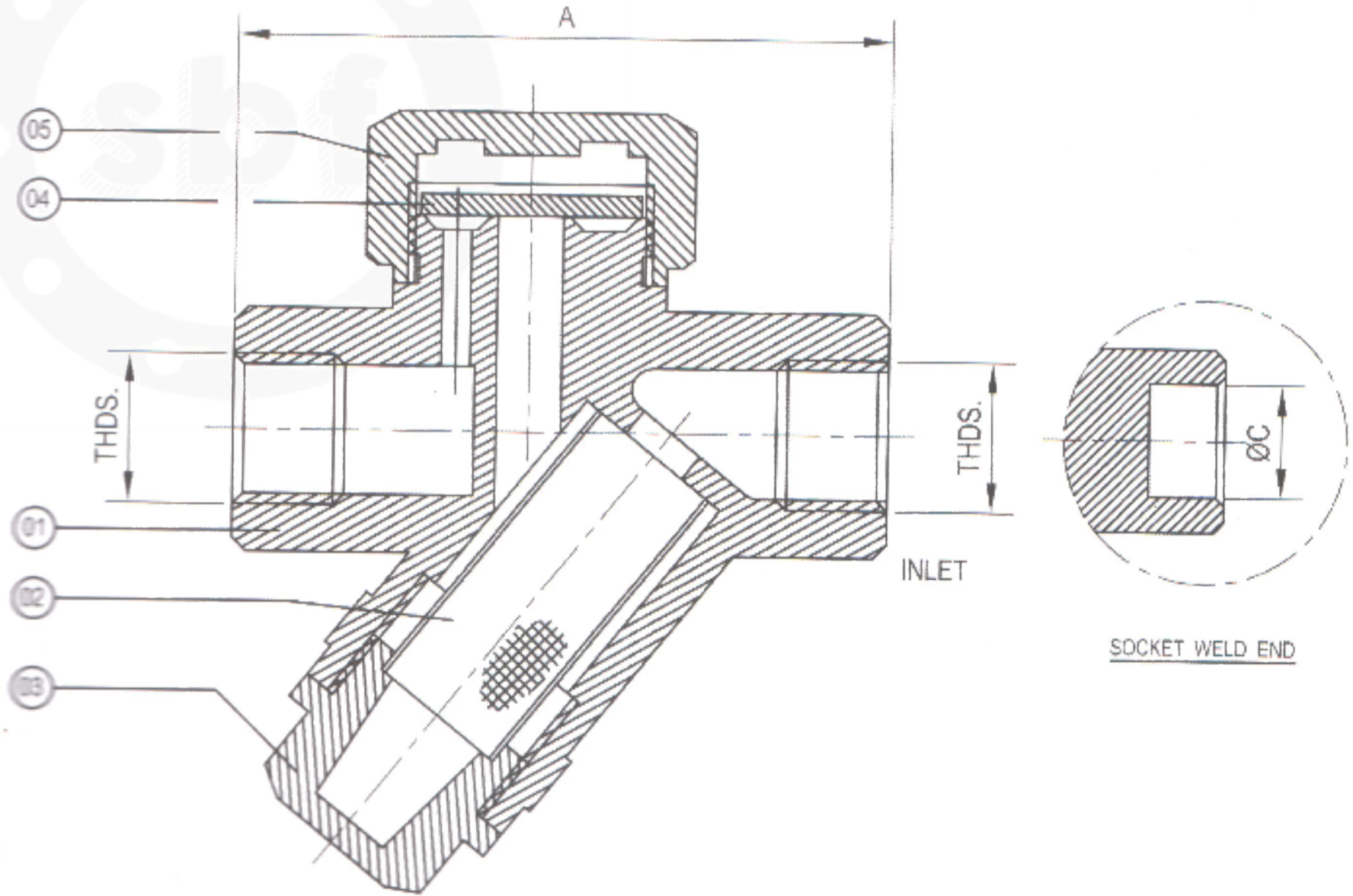

BUCKET TYPE STEAM TRAP

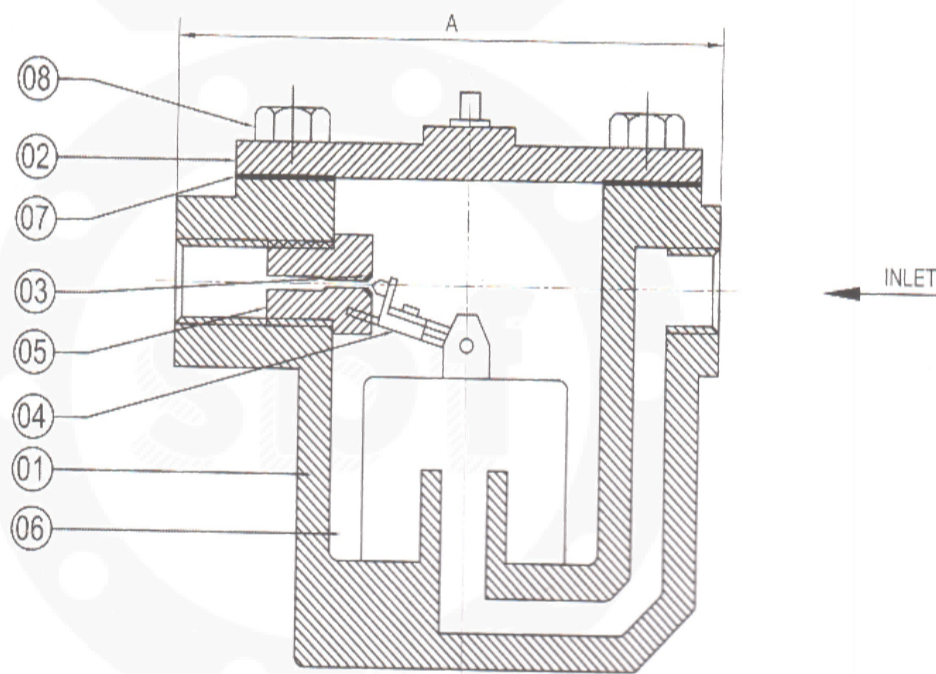

NO	DESCRIPTION	MATERIAL	QTY.
01	BODY	C.I. IS:210 GR.220	1
02	COVER	C.I. IS:210 GR.220	1
03	SEAT	S.S. 304	1
04	VALVE	GUN METAL	1
05	NIPPLE	GUN META	1
06	BUCKET	S.S.	1
07	GASKET	GRAPHITE	1
08	NUT & BOLT	CARBON STEEL	--

TECHNICAL DATA

DESIGN & MANUFACTURING STD.	IS 12268
TESTING & INSPECTION STD.	IS 12268
END CONNECTIONS	SCREWED BSF(F)

PRIMARY SERVICE RATING & TEST PRESSURE

CLASS	WORKING PRESSURE	TEMP.	HYP. TEST PRESSURE	
			BODY	SEAT
150	150 PSIG	220°C	300 PSIG	

AIR TEST - SEAT 80 PSIG + 10 PSIG

SIZE

M.M	INCH	A
15	1/2"	177
20	3/4"	177
25	1"	188
40	1.1/2"	252
50	2"	252

FORGED STEEL GATE VALVE (800#)

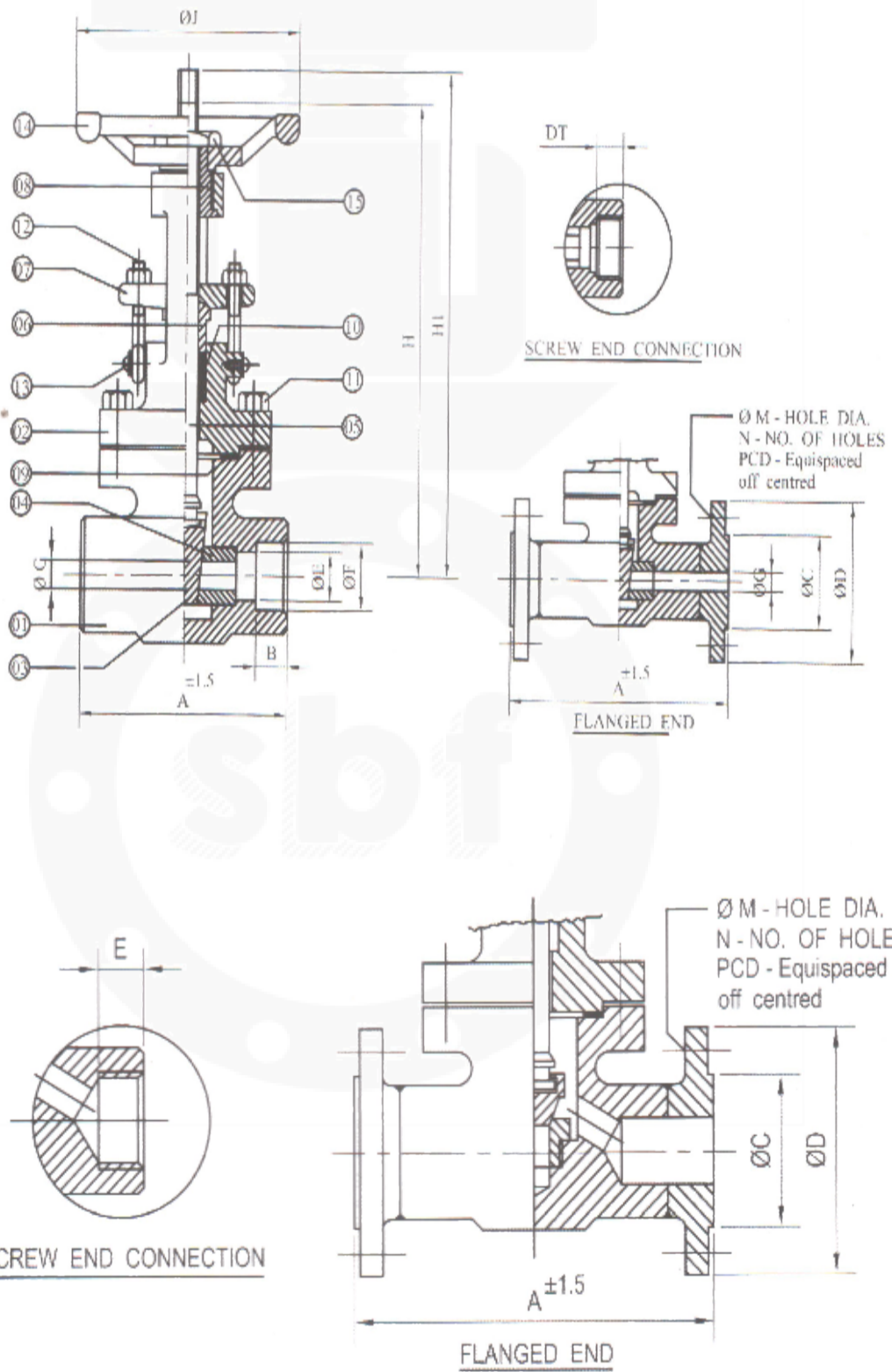

NO	DESCRIPTION	MATERIAL	QTY.
01	BODY	FORGE STEEL A105/F304/F314	1
02	BONNET	FORGE STEEL A 105/F304/F314	1
03	WEDGE	AISI 304 / AISI 316 / 13% CR. S.S.	1
04	SEAT RING	AISI 304 / AISI 316 / 13% CR. S.S.	2
05	STEAM	AISI 304 / AISI 316 / AISI 410	1
06	GLAND BUSH	AISI 304 / AISI 316 / AISI 410	1
07	GLAND FLANGE	ASTM A 105	1
08	YOKE SLEEVE	SGI	1
09	BONNET GASKET	SPIRAL WOUND S.S. 304	1
		WITH CAF	1
10	GLAND PACKING	S.S. METAL WIRE BRAIDED ASBESTOS	--
11	BONNET STUD & NUT	ASTM A 193 Gr. B7 ASTM A 194 Gr. 2H	4 SET
12	EYE BOLT & NUT	FORGED C.S	2 SET
13	SCREW & WASHER	M.S. GALVANISHED	2 SET
14	HAND WHEEL	CAST IRON / C.S.	1
15	HAND WHEEL NUT	CARBON STEEL	

TECHNICAL DATA	
DESIGN & MANUFACTURING STD.	API 602
TESTING & INSPECTION STD.	API 598
SOCKET WELD AND THREADED TO	ANSI B 16.11 / ANSI B 1.20.1
FLANGED TO	ANSI B 16.5
FLANGED TO FLANGE DISTANCE	ANSI B 16.10

PRIMARY SERVICE RATING & TEST PRESSURE				
CLASS	WORKING PRESS.	TEMP.	HYD. TEST PRESS	
			BODY	SEAT
800		300° C	3000 PSIG	2000 PSIG

SIZE		SCREWED / SOCKED WELD								
IN	M.M.	A	B	Ø E	Ø F	Ø G	H	HI	DT	Ø J
1/2"	15	85	10	13	22.0	9.0	154	174	13	94
3/4"	20	90	13	15	27.5	14.0	160	185	13	94
1"	25	105	13	22	34.0	18.0	168	198	15	98
1.1/2"	40	128	13	36	48.6	32.0	231	274	25	142
2"	40	142	16	45	61.1	42.0	242	287	25	142

SIZE		CLASS - 150						
IN	M.M.	A	Ø C	Ø D	Ø G	Ø M	N	P.C.D.
1/2"	15	108	35	89	11	16	4	60.4
3/4"	20	118	43	98	13	16	4	70.0
1"	25	127	51	108	14	16	4	79.0
1.1/2"	40	165	73	127	14	16	4	98.5
2"	50	178	92	152	16	19	4	120.6

KNIFE EDGE GATE VALVE

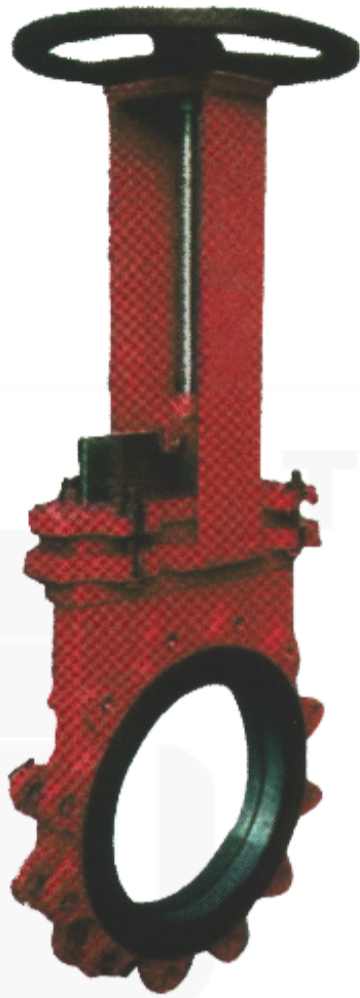

NO	DESCRIPTION	MATERIAL	QTY.
01	BODY	WCB / CF 8 / CF8M	1
02	GATE	SS 410 / SS 304 / SS 316	1
03	SEAT	METAL TO METAL, EPDM , PTFE	1
04	GLAND PACKING	PTFE / GRAPHITE	1
05	GLAND	CI / WCB / Cf8 / CF8M	1
06	STEM	SS 410 / SS 304	1
07	YOKE SLEEV	GUN METAL	1
08	STEAM NUT	SG IRON	1
09	HAND WHEEL	SG IRON	1
10	NUTS & BOLTS	CS / MS	--

TECHNICAL DATA

DESIGN & MANUFACTURING STD.	MSS - SP 81
FACE TO FACE	
END CONNECTIONS:	
TESTING STD :	

PRIMARY SERVICE RATING & TEST PRESSURE

CLASS	WORKING PRESS.	TEMP.	HYD. TEST PRESS	
			BODY	SEAT
150	150 PSIG (21 kg/Cm2)	200° C	425 PSIG	40 PSIG

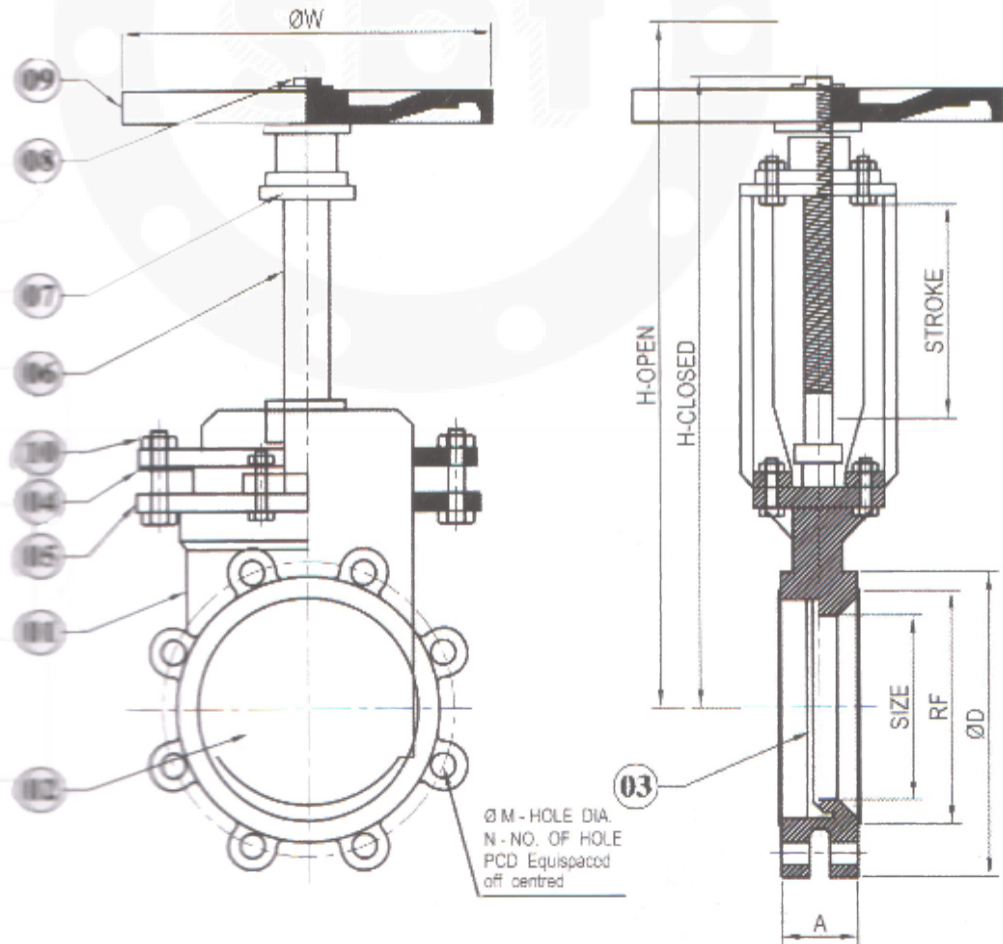

SIZE		CLASS - 150								
IN	M.M	A	ØC	ØD	ØM	N	P.C.D	ØW	H.OPEN	H-CLO- SED
2"	40	47.6	152	92	16	4	120	203	406.4	346
3"	80	50.8	184	152	16	4	152	203	501	406.4
4"	100	50.8	228.6	156	16	8	190.5	203	549	450
6"	150	57.15	279	216	19	8	241.3	305	705	549
8"	200	69.85	343	270	19	8	298.5	305	705	549
10"	250	69.85	406	324	22	12	362	381	1085	816
12"	300	76.20	482	381	22	12	432	381	1235	924
14"	350	76.20	533	413	25	12	476	381	1403	1066.8
16"	400	89	597	470	25	16	540	508	1603	1187
18"	457	89	635	533	28.5	16	578	508	1790	1330
20"	508	114	698.5	584	28.5	20	635	508	2457	1936
24"	610	114	813	693	31.75	20	750	508	2949	2317

PLUG VALVE SELF LUBRICATING



NO	DESCRIPTION	MATERIAL	QTY.
01	BODY	C.I / CS / Cf8 / Cf8 M	1
02	PLUG	C.I / CS / Cf8 / Cf8 M	1
03	COVER	C.I / CS / Cf8 / Cf8 M	1
04	GLAND	C.I / CS / Cf8 / Cf8 M	1
05	NON RETURN VALVE	M.S / S.S.	1
06	GLAND PACKING	GRAPHITED ASBESTOS	1
07	BODY GASKET	CAF / PTFE	1
08	DIAPHRAGM	M.S / S.S. 304 / S.S. 316	1
09	BODY STUD & NUT	ASTM B-7, 1 S.S.	---
10	STEM	M.S. / S.S.	1

TECHNICAL DATA	
DESIGN & MANUFACTURING STD.	-
TESTING & INSPECTION STD.	BS 5146
FACE TO FACE	AS PER ANSI B 16.10
END CONNECTIONS :	FLANGED AS PER ANSI B-16.5
TEST PRESSURE	

PRIMARY SERVICE RATING & TEST PRESSURE		
CLASS	HYD. TEST PRESS	
	BODY	SEAT
150#	22 kg/Cm2	16 kg/Cm2

SIZE		CLASS - 150						
IN	M.M	A	B	ØC	ØD	ØM	N	P.C.D
1/2"	15	121	11.1	35	88	16	4	59
3/4"	20	121	12.7	43	97	16	4	70
1"	25	141	14.2	51	108	16	4	78
1.1/2"	40	165	17.5	73	124	19	4	98
2"	50	178	19	92	149	19	4	119
2.1/2"	65	190	22.3	105	173	19	4	140
3"	80	203	24	127	189	19	4	150
4"	100	229	24	157	224	19	8	190
5"	125	267	24	186	250	22	8	208
6"	150	292	25	216	276	22	8	240
8"	200	330	28.5	270	340	22	8	298

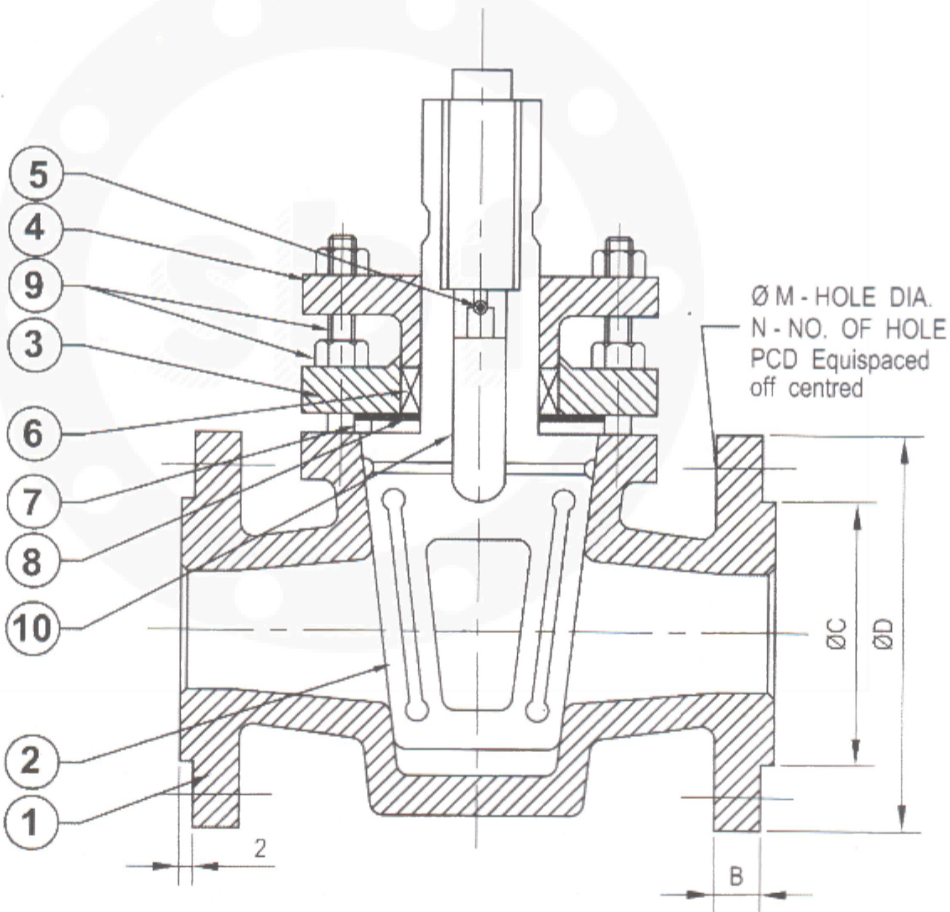

JACKETED BALL VALVE FLANGE END (150#)

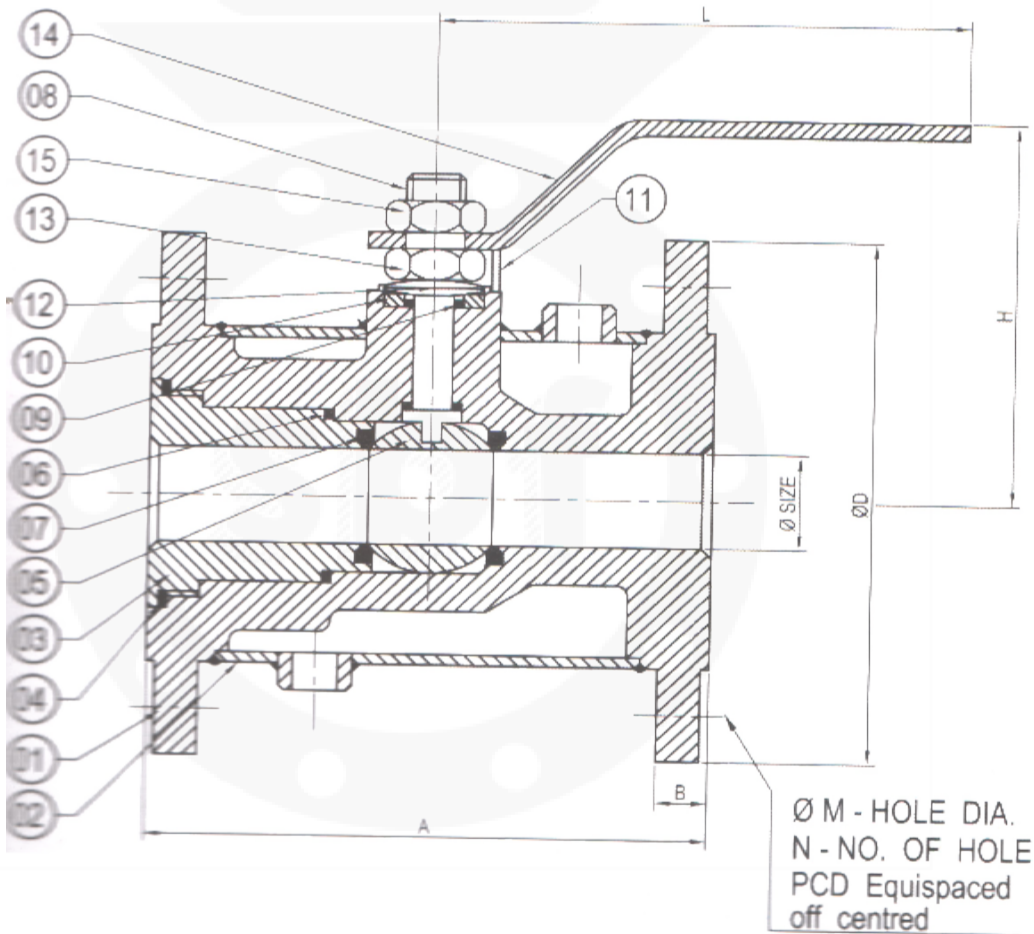

NO	DESCRIPTION	MATERIAL	QTY.
01	BODY	ASTM A 216 Gr. WCB A 351 GR. CF8/AISI 304 A 351 GR. CF8M / AISI 316	1
02	JACKET	MILD STEEL / AISI 304/316	1
03	BODY NUT	ASTM A 216 Gr. WCB A 351 GR. CF8/AISI 304 A 351 GR. CFM/AISI 316	1
04	BODY SEAL	PTFE OR FILLED PTFE	1
05	BALL	AISI 304/AISI 316	1
06	SEAL	PTFE OR FILLED PTFE	1
07	SEAT SEAL	GLASS FILLED TEFLON	2
08	STEM	AISI 304/AISI 316	1
09	GLAND PACKING	PTFE OR FILLED PTFE	2
10	GLAND	AISI 304/AISI 316	1
11	STOPPER PIN	STEEL	1
12	BILLEVILLE SPRING	STEEL	1
13	GLAND NUT	AISI 304/AISI 316	1
14	LEVER	CARBON STEEL / AISI 304	1
15	LOCK NUT	STEEL(PLATED) AISI 304	1

TECHNICAL DATA	
DESIGN & MANUFACTURING STD.	BS 5351
PNEUMATIC TESTING	BS 5145
FACE TO FACE	AS PER ANSI B 16.10
SEAT AIR :	7 kg/cm ²
JACKET TESTING :	7 kg/cm ²
HYDROSTATIC TESTING :	BS 6755 (1)
HYDRO SHELL	31 kg/cm ²
HYDRO SEAT	22 kg/cm ²

PRIMARY SERVICE RATING & TEST PRESSURE				
CLASS	WORKING PRESS.	TEMP.	HYD. TEST PRESS	
			BODY	SEAT
150	150 PSIG	200° F	425 PSIG	300 PSIG

SIZE		CLASS - 150					
MM	A	B	ØC	ØD	ØM	N	P.C.D
25 X 40	127	14.3	73	127	15.8	4	98.5
40 X 50	165	15.8	92.1	152.4	19	4	120.6
50 X 65	178	17.7	107.7	177.8	19	4	139.7
50 X 80	178	19	127	190.5	19	4	152.4
65 X 80	190	19	127	190.5	19	4	152.4
80 X 100	203	23	157.2	228.6	19	8	190.5
100 X 150	229	25.4	215.9	279	22	8	241.3

DIAPHRAGM OPERATED CONTROL VALVE (150#)



NO	DESCRIPTION	MATERIAL	QTY.
01	BODY	ASTM A 216 Gr. WCB	1
02	BONNET	ASTM A 216 Gr. WCB	1
03	BONNER FLANGE	ASTM A 216 Gr. WCB	1
04	STEM	AISI 304/AISI 410	1
05	PLUG	AISI 304/AISI 410	1
06	SEAT RING	AISI 304/AISI 410	2
07	GLAND BUSH	AISI 304/AISI 410	1
08	GLAND PLATE	M.S.	1
09	BONNET STUD & NUT	ASTM A 193 Gr. B7 ASTM A 194 Gr. 2D	---
10	ACTUATOR	ALUMINIUM / MS	1
11	GLAND PACKING	METALIC WIRE REINFORGED GRAPHITED ASBESTOS	1

TECHNICAL DATA

DESIGN & MANUFACTURING STD.	ANSI B 16.37 / API 598
TESTING & INSPECTION STD.	FCI - 702 / ISA * RP - 39.6
SEAL LEAKAGE STD.	ANSI B 16.5
END CONNECTIONS:	

PRIMARY SERVICE RATING & TEST PRESSURE

CLASS	WORKING PRESS.	TEMP.	HYD. TEST PRESS	
			BODY	SEAT
150#	150 PSIG	500° F	425 PSIG	300 PSIG

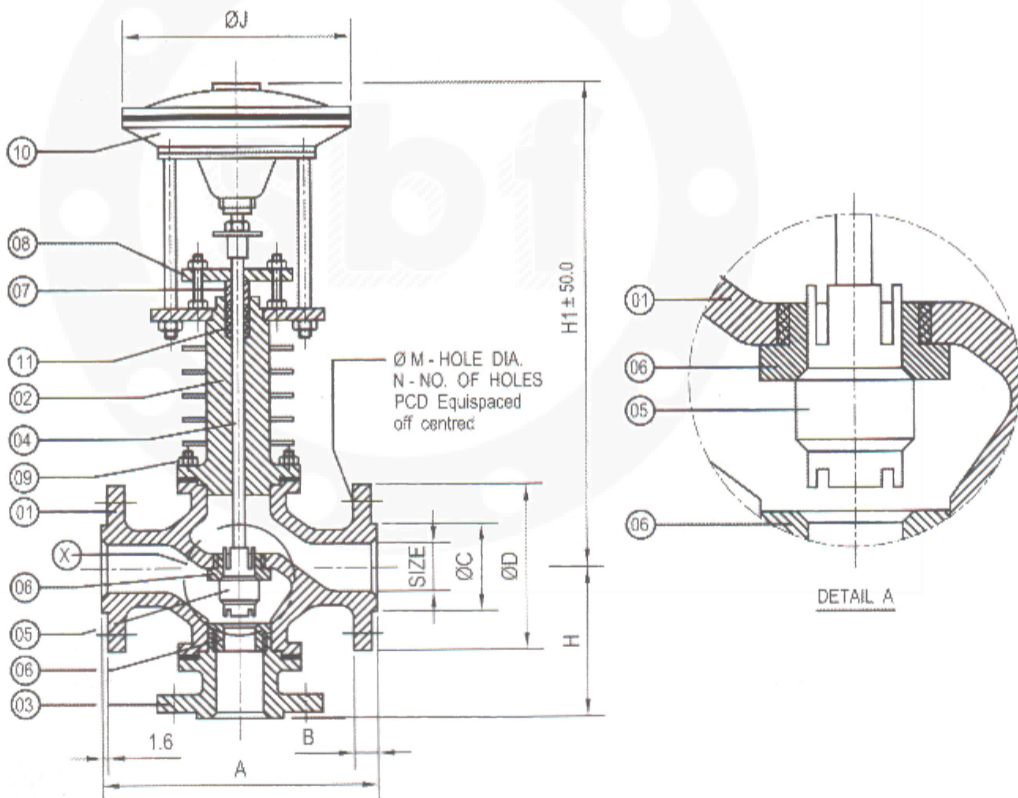

SIZE		CLASS - 150									
IN	M.M	A	B	ØC	ØD	H	HI	ØM	N	P.C.D	ØJ
1"	25	184	11.0	51	108.0	143	595	16	4	79.0	290
1.1/2"	40	222	14.2	73	127	200	595	16	4	98.5	290
2"	50	254	15.7	92	152.0	220	675	19	4	120.6	290
2.1/2"	65	276	17.5	105	178.0	250	695	19	4	139.7	290
3"	80	298	19.5	127	190.5	265	700	19	4	152.4	380
4"	100	352	24.0	157	229.0	290	400	19	8	190.4	525

1PC / 3PC Ball Valve



MOC : CI , IC CF8 /CF8M,
A105
DESIGN : 1PC , 3PC
END : SCREWED END
BSP(F),NPT(F)
SIZE : 8 MM TO 100MM

Sight Glass Valve



MOC : M.S.,IC CF8/ CF8M
END : FLANGED END ASA
150#
DESIGN : LN KEY,CHECKNUT
WITH T BUSH
LENGTH : TOUGHENED
BOROSIL
SIZE : 15MM TO 150MM

Double window sight glass valve



MOC : WCB,IC CF8/CF8M
END :FLANGED END ASA
150#
SEAT : PTFE
GLASS : TOUGHENED
BOROSIL
SIZE : 25MM TO 150MM

Needle valve



MOC : CI , IC CF8 /CF8M,
A105
DESIGN : 1PC , 3PC
END : SCREWED END
BSP(F),NPT(F)
SIZE : 8 MM TO 100MM

Pinch Valve



MOC : CI ,SGI ,ALUMINIUM
DESIGN : CLOSE BODY
END : FLANGED END "D"
TABLE
SLEEVE : NATURAL RUBBER
SIZE : 25 MM TO 200MM

Ball Float Type Steam Trap



MOC : CI , IC CF8 /CF8M,
A105
DESIGN : 1PC , 3PC
END : SCREWED END
BSP(F),NPT(F)
SIZE : 8 MM TO 100MM

Moisture Separator



MOC : M.S.
CARTRIDGE : IMPORTED S.S.
WORKING PRESS : UPTO
10KG/CM2
END : SCREWED END BSP(F),
FLANGED END
SIZE : 15MM TO 50MM

Spherical Disc Butterfly Valve



MOC : WCB,IC CF8/IC CF8M
SEAT : PTFE, GFT
END : WEFAT TYPE SUIT TO
150#
OPERATION: LEVER,GEAR,
ACTUATOR
SIZE : 50 MM TO 250MM